

USG SC3280
ENSEMBLE™ ACOUSTICAL DRYWALL CEILING
DIRECT MOUNT SYSTEM DETAILS

USG MAKES THE USG PRODUCT DETAILS CONTAINED HEREIN
INTENDED FOR USE AS PRODUCT REFERENCE MATERIAL BY
ARCHITECTS, ENGINEERS, OTHER DESIGN PROFESSIONALS,
CONTRACTORS, BUILDING CODE OFFICIALS, OR OTHER
COMPETENT CONSTRUCTION INDUSTRY TRADE PROFESSIONALS
HAVING AN INTEREST IN THE SELECTION, SPECIFICATION AND
USE OF PRODUCTS MANUFACTURED BY THE SUBSIDIARIES OF
USG CORPORATION. THE DRAWINGS ARE INTENDED TO BE A
TECHNICAL SUPPORT INCIDENT TO THE SALE AND USE OF USG
PRODUCTS AND NOT INTENDED TO BE A SUBSTITUTE FOR THE
DESIGN REVIEW AND APPROVAL OF THE LICENSED DESIGN
PROFESSIONALS FOR THE PROJECT. THESE MATERIALS MAY BE
PRINTED AND/OR TRANSFERRED ELECTRONICALLY SOLELY AS
NEEDED BY THE USER, BECAUSE CAD ELECTRONIC FILES AND
BIM BUILDING INFORMATION MODELING (BIM) FILES CAN BE
MODIFIED BY OTHER PARTIES, WITHOUT NOTICE OR INDICATION
OF SUCH MODIFICATIONS, MODIFICATION OF USG PRODUCT CAD
DRAWINGS IS THE SOLE RESPONSIBILITY OF THE DESIGN
PROFESSIONAL.

ISSUE LOG	
0	08.21.2019
1	03.18.2020
2	05.17.2021
3	06.14.2021
4	03.04.2022

SHEET INFORMATION
USG ENSEMBLE™
ACOUSTICAL
DRYWALL CEILING

E01

1 OF 1

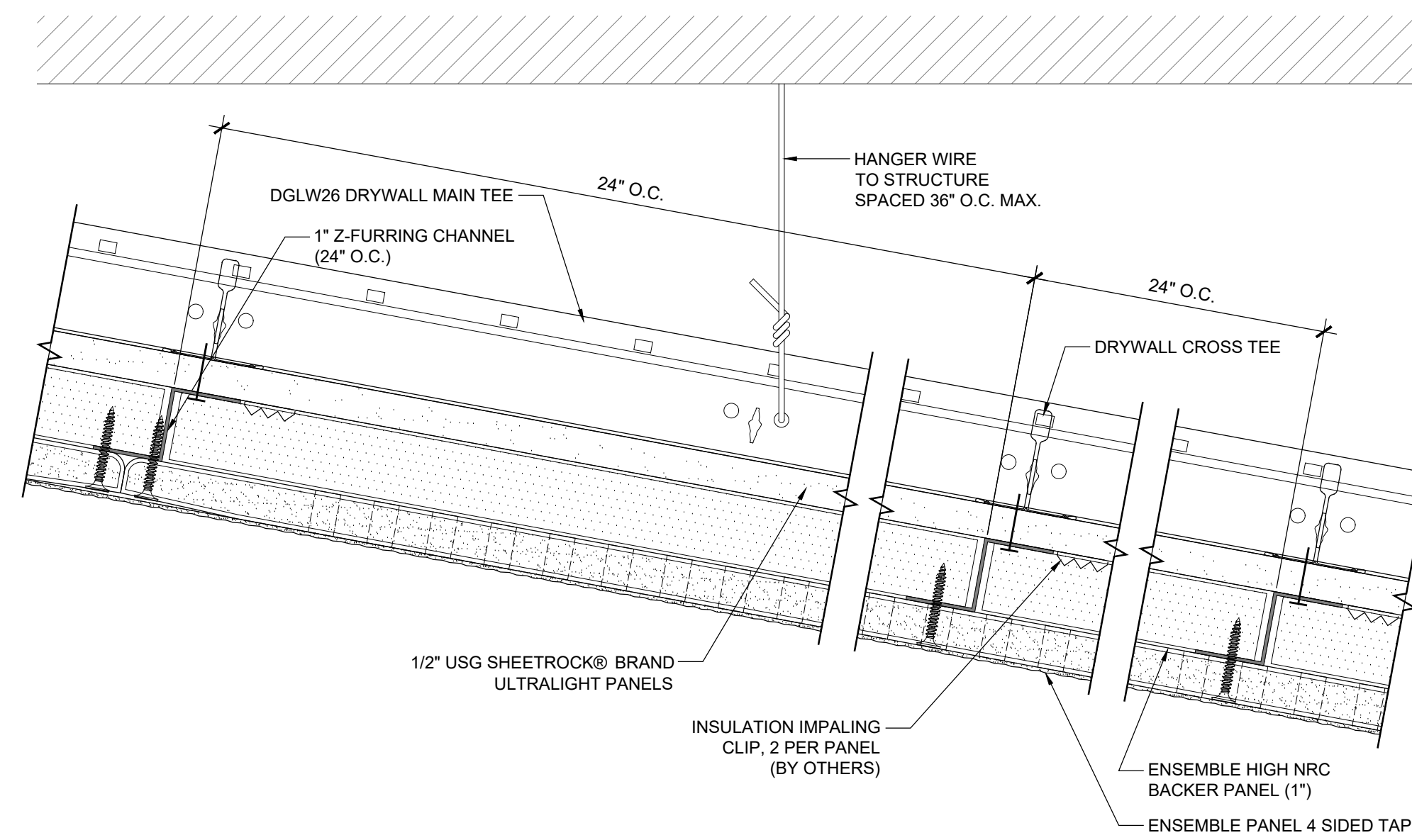

6
SUSPENDED DRYWALL CEILING
SLOPED DIRECT MOUNT DETAIL
SCALE: 6" = 1'-0"

SUITABLE FOR RETURN-AIR CEILING PLENUM WITH
DIFFERENTIAL PRESSURE WHEN DIRECT MOUNTED TO DRYWALL
CEILING SYSTEM. REFER TO LOAD TABLE ON PAGE 12 OF USG
LITERATURE AC3152 FOR GRID & HANGER WIRE REQUIREMENTS.
ALL PENETRATIONS MUST BE SEALED WITH
USG SHEETROCK® BRAND FIRECODE® SMOKE-SOUND SEALANT.

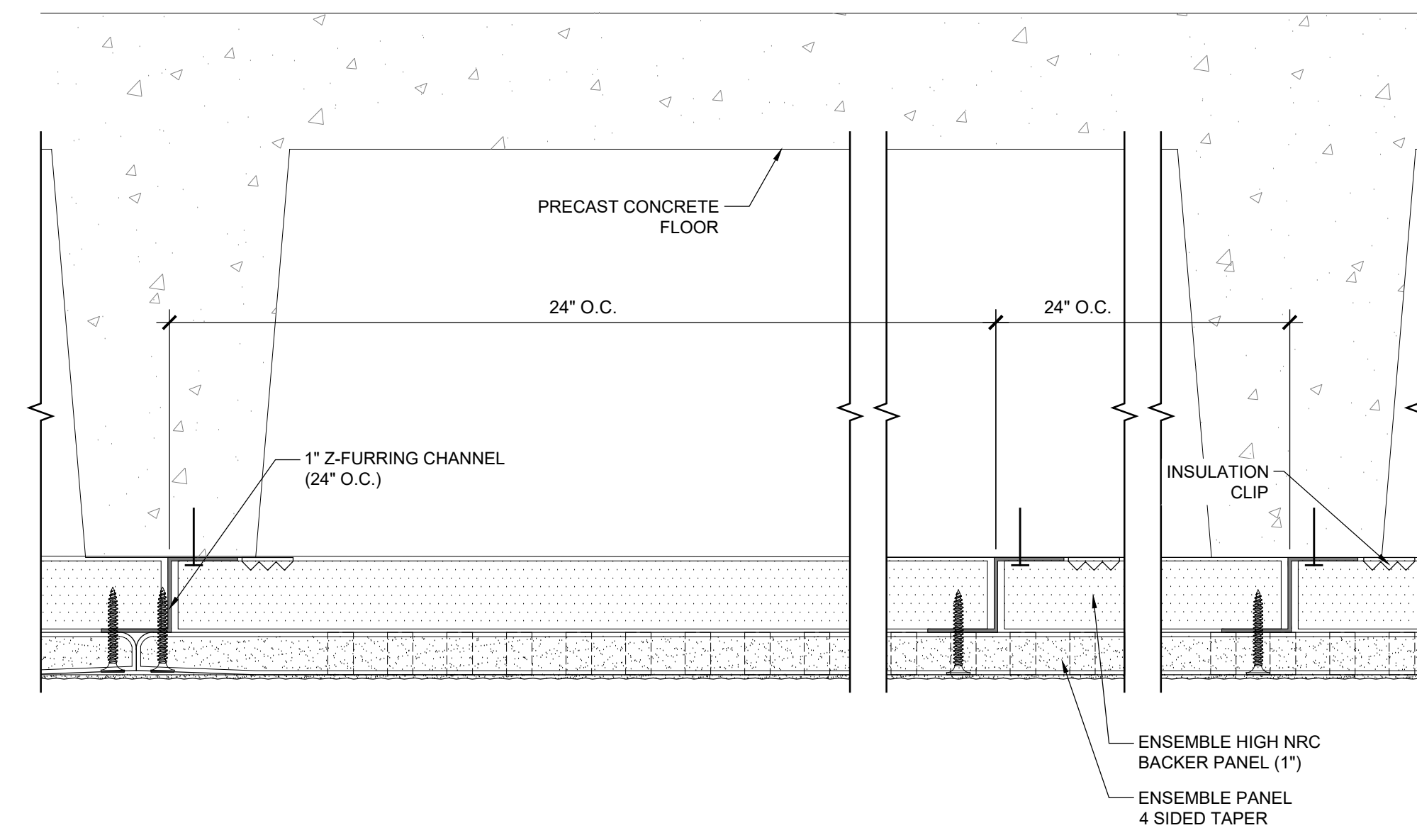

3
PRECAST CONCRETE FLOOR
HORIZONTAL DIRECT MOUNT DETAIL
SCALE: 6" = 1'-0"

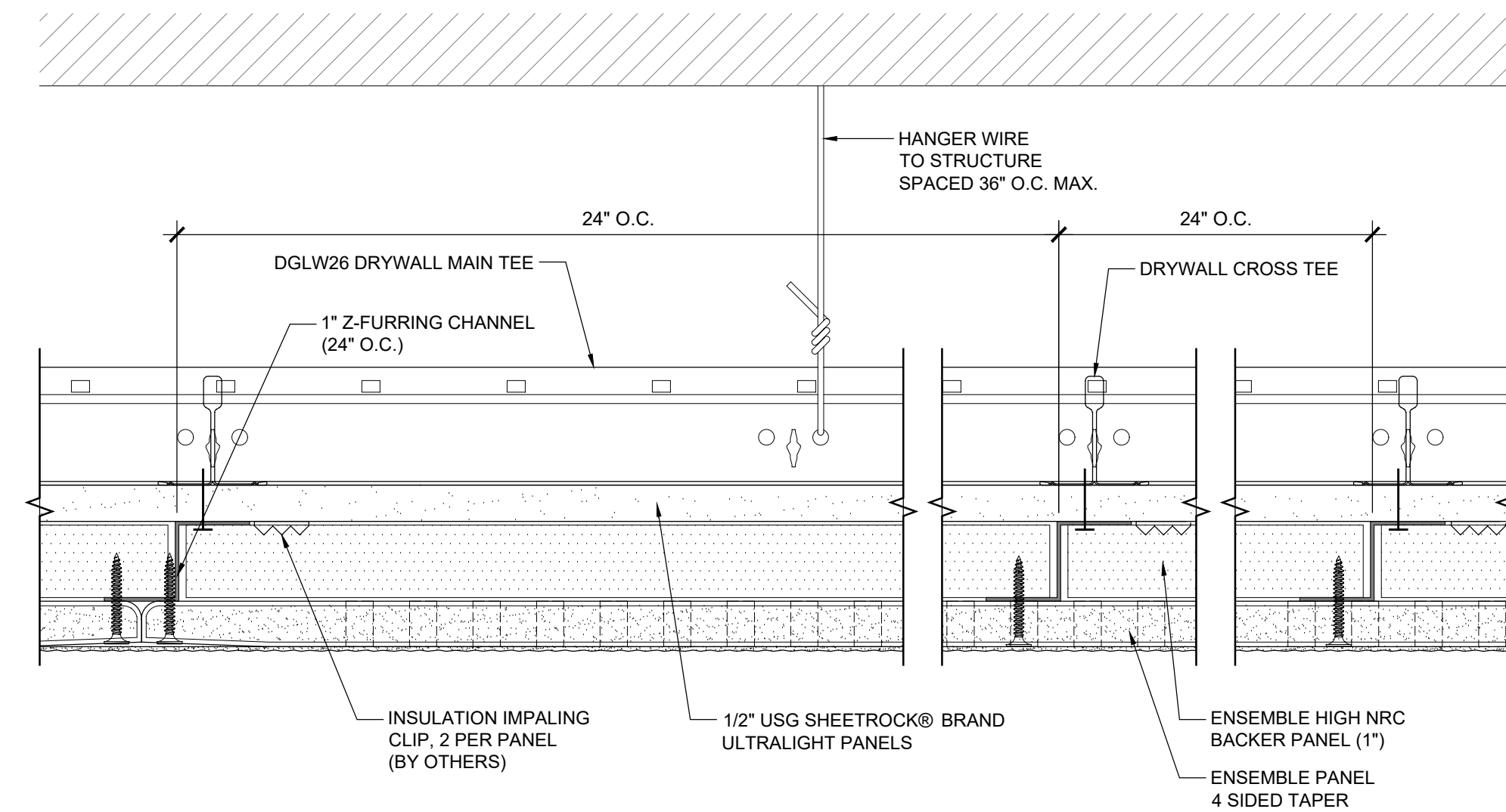

5
SUSPENDED DRYWALL CEILING
HORIZONTAL DIRECT MOUNT DETAIL
SCALE: 6" = 1'-0"

SUITABLE FOR RETURN-AIR CEILING PLENUM WITH
DIFFERENTIAL PRESSURE WHEN DIRECT MOUNTED TO DRYWALL
CEILING SYSTEM. REFER TO LOAD TABLE ON PAGE 12 OF USG
LITERATURE AC3152 FOR GRID & HANGER WIRE REQUIREMENTS.
ALL PENETRATIONS MUST BE SEALED WITH
USG SHEETROCK® BRAND FIRECODE® SMOKE-SOUND SEALANT.

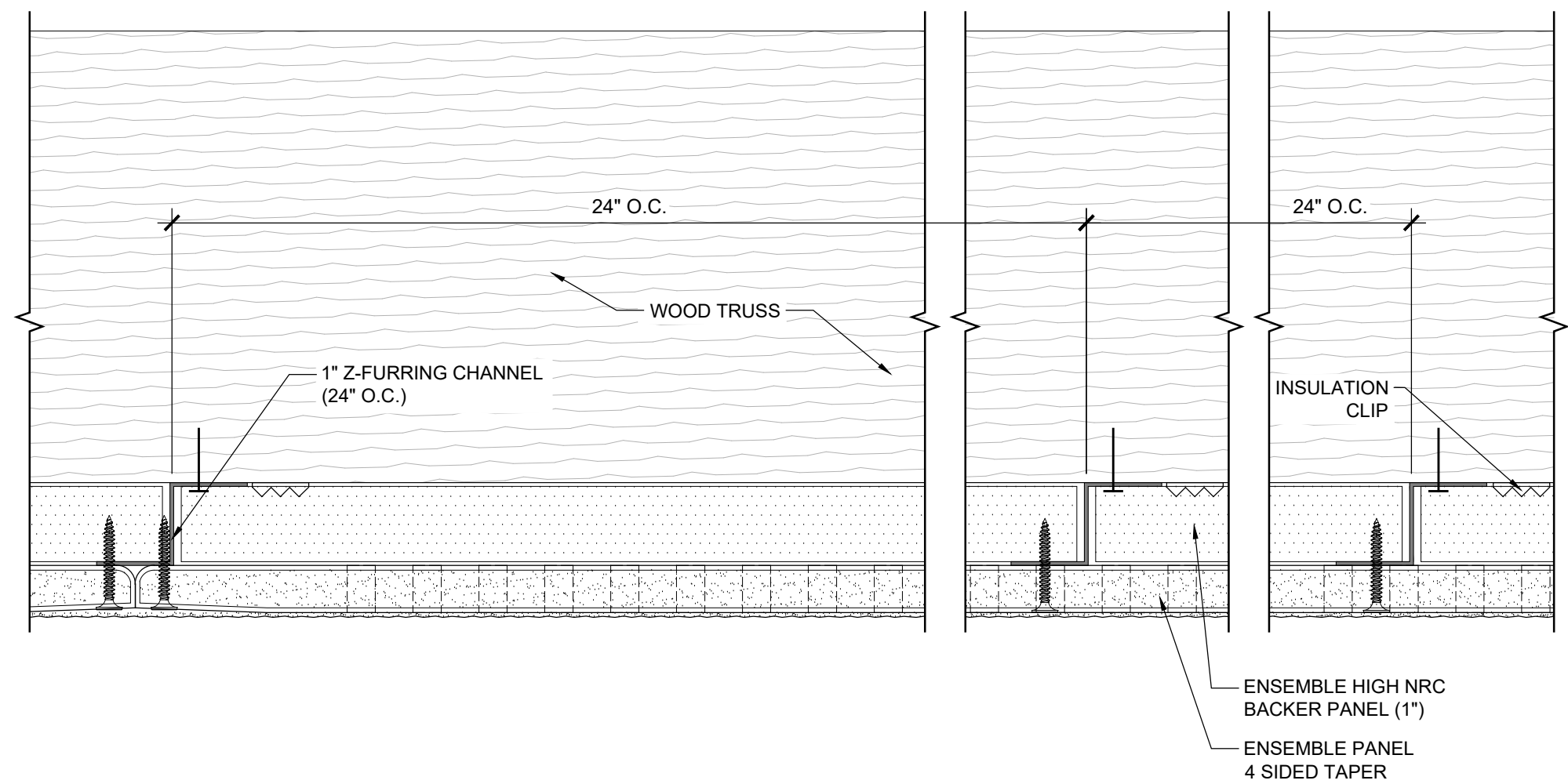

2
WOOD TRUSS
HORIZONTAL DIRECT MOUNT DETAIL
SCALE: 6" = 1'-0"

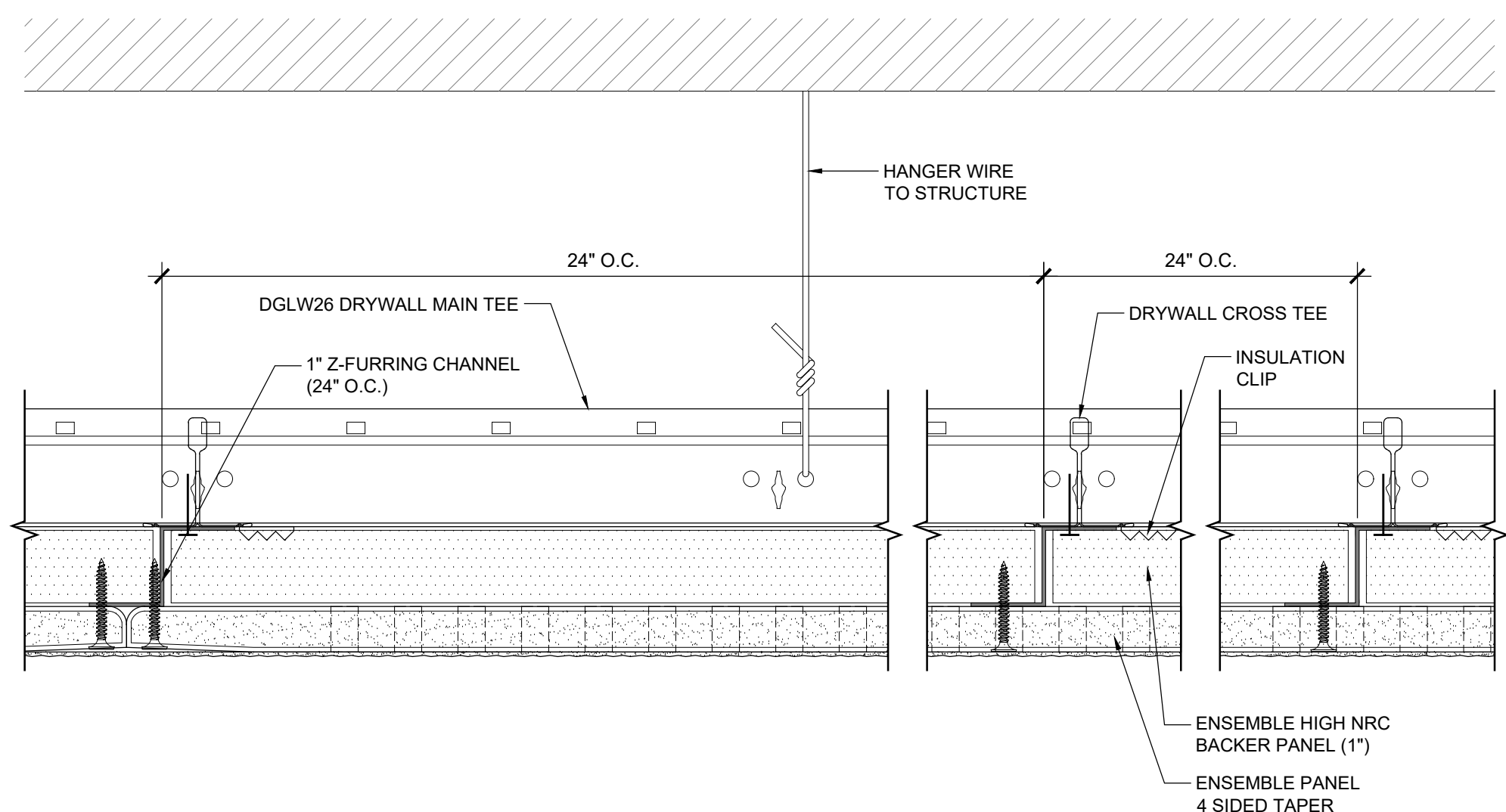

4
DRYWALL SUSPENSION SYSTEM
HORIZONTAL DIRECT MOUNT DETAIL
SCALE: 6" = 1'-0"

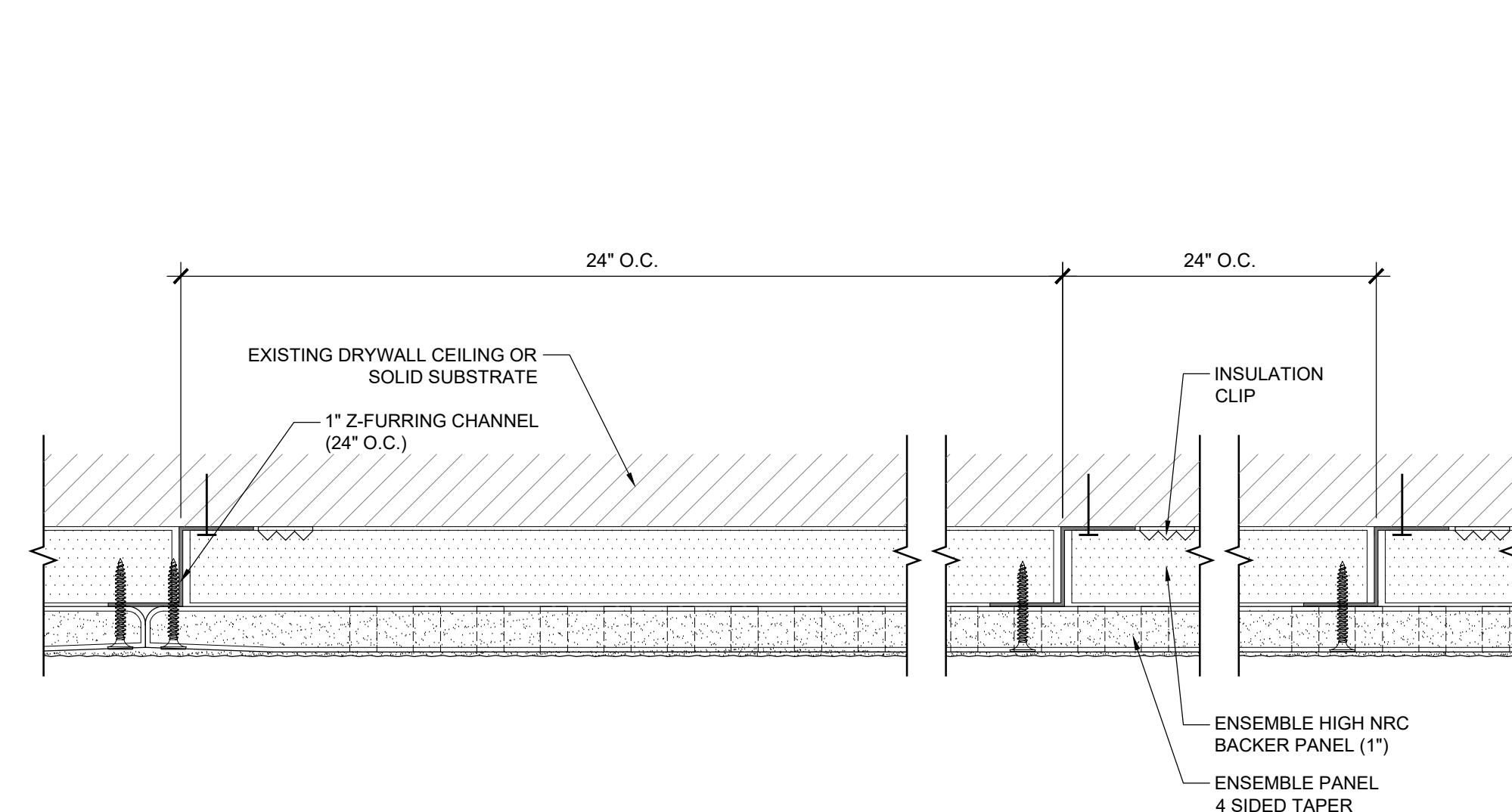

1
STRUCTURE
HORIZONTAL DIRECT MOUNT DETAIL
SCALE: 6" = 1'-0"

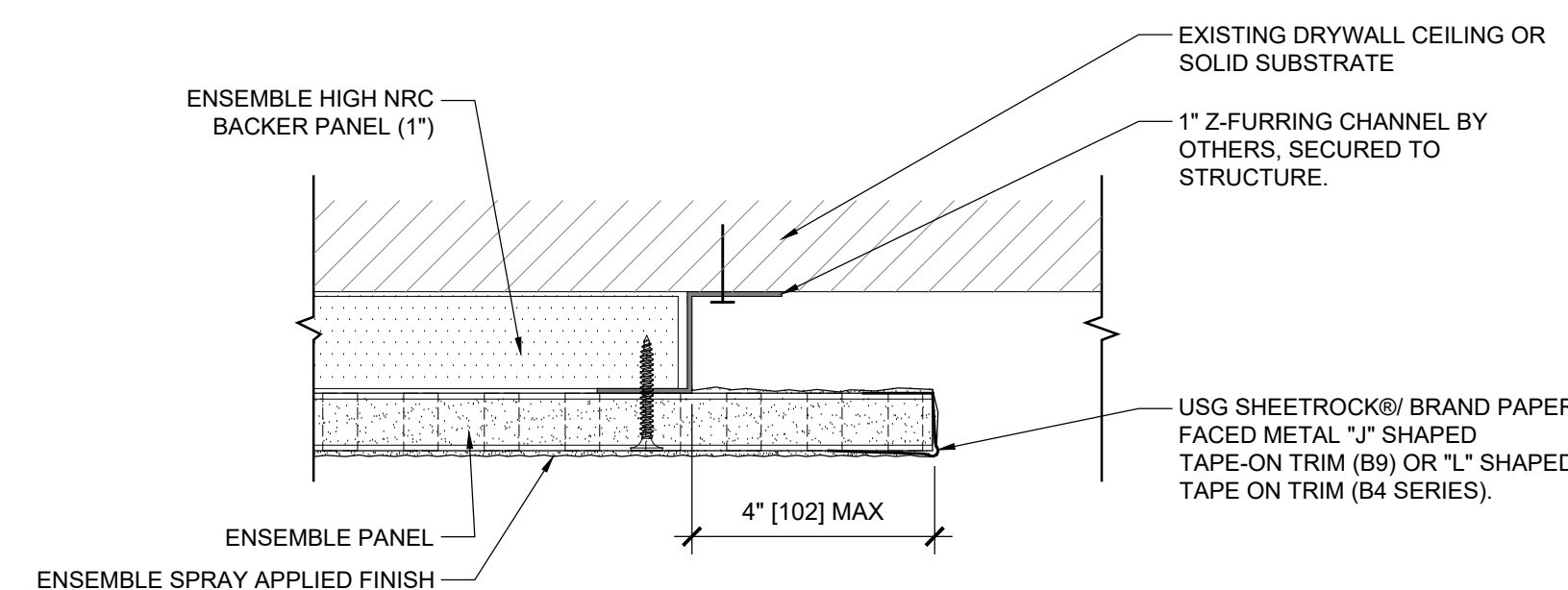

7
USG ENSEMBLE CEILING
DIRECT MOUNT DETAIL CANTILEVER EDGE
SCALE: 6" = 1'-0"