

DESIGN NO.      GA WP 4232

FIRE RATING:  
STC RATING:  
SOUND TEST:  
SYSTEM THICKNESS:  
LOCATION:  
FRAMING TYPE:

2 HOURS  
53  
USG-171047  
11-3/4" [298 mm]  
INTERIOR  
WOOD STUD (LOAD-BEARING)

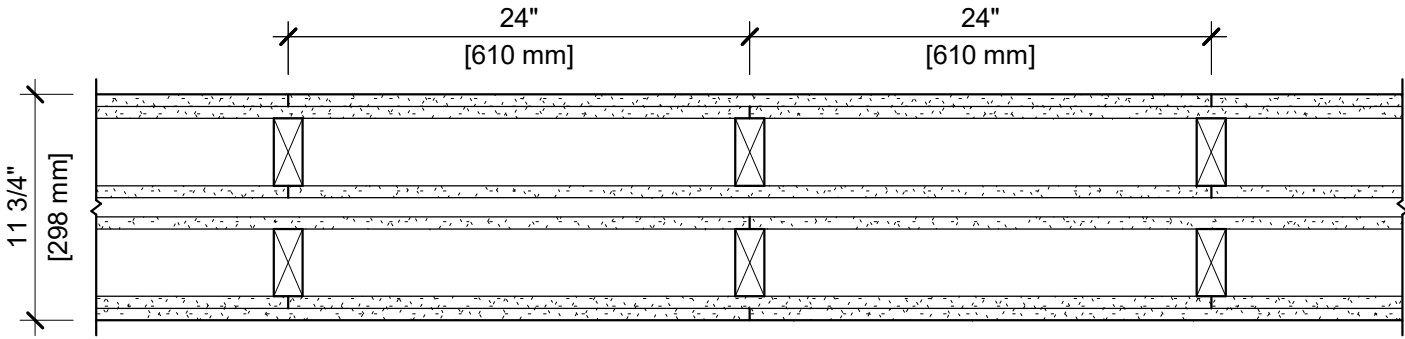

ASSEMBLY REQUIREMENTS:

GYPSUM PANELS:  
WOOD STUDS:  
GYPSUM PANELS:  
AIR SPACE:  
GYPSUM PANELS:  
WOOD STUDS:  
GYPSUM PANELS:

TWO LAYERS 5/8" [15.9 mm] SHEETROCK® ECOSMART GYPSUM PANEL (UL TYPE ULIX™)  
2" X 4" [38 X 89 mm] WOOD STUDS, 24" [610 mm] O.C.  
ONE LAYER 5/8" [15.9 mm] SHEETROCK® ECOSMART GYPSUM PANEL (UL TYPE ULIX™)  
1" [25 mm] AIR SPACE  
ONE LAYER 5/8" [15.9 mm] SHEETROCK® ECOSMART GYPSUM PANEL (UL TYPE ULIX™)  
2" X 4" [38 X 89 mm] WOOD STUDS, 24" [610 mm] O.C.  
TWO LAYERS 5/8" [15.9 mm] SHEETROCK® ECOSMART GYPSUM PANEL (UL TYPE ULIX™)

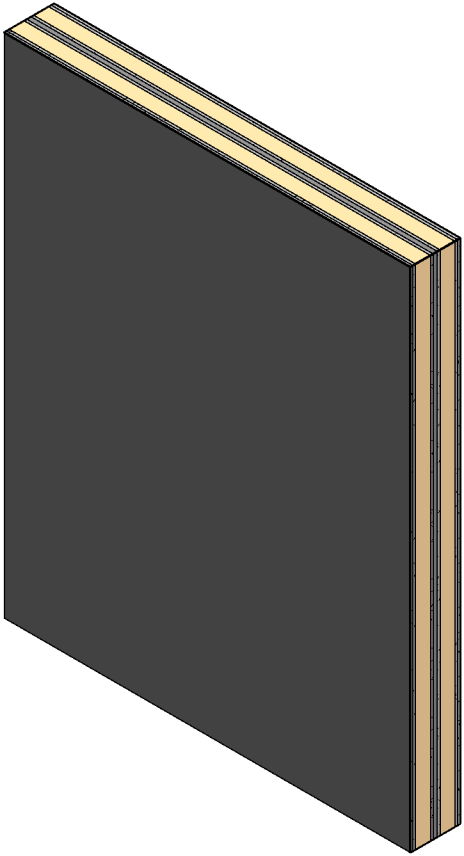

- GENERAL WALL NOTES:**
- REFER TO APPLICABLE CODES REQUIREMENTS TO ENSURE COMPLIANCE PRIOR TO CONSTRUCTION.
  - FOR THE MOST UP-TO-DATE DETAILS, INCLUDING CONSTRUCTION VARIATIONS, REFER TO THE PUBLISHED DESIGN.
  - WHERE DESIGN NO. INDICATES "PER", THE FIRE RATING IS BASED ON LABORATORY TEST DATA OF THE REFERENCED SIMILARLY CONSTRUCTED ASSEMBLIES.
  - STUD SIZES AND INSULATION THICKNESS ARE MINIMUM UNLESS OTHERWISE STATED IN THE PUBLISHED ASSEMBLY.
  - STUD AND FASTENER SPACINGS ARE MAXIMUM UNLESS OTHERWISE STATED IN THE PUBLISHED ASSEMBLY.
  - PANEL ORIENTATION SHALL BE AS SPECIFIED IN THE PUBLISHED DESIGN.
  - FIRE-RATINGS ARE FROM BOTH SIDES UNLESS OTHERWISE STATED.
  - FIRE-RATINGS ARE MAINTAINED WITH ONE OR MORE OF THE FOLLOWING MODIFICATIONS: INCREASE STUD DEPTH, INCREASE STUD MATERIAL THICKNESS, DECREASE STUD SPACING, DECREASE FASTENER SPACING, INCREASE INSULATION THICKNESS UP TO CAVITY DEPTH.
  - WHERE ACOUSTICAL PERFORMANCE IS PROVIDED IN AN ESTIMATED RANGE, THE VALUES ARE BASED ON LABORATORY TEST DATA OF SIMILARLY CONSTRUCTED ASSEMBLIES.
  - SOUND-RATINGS ARE MAINTAINED WITH ONE OR MORE OF THE FOLLOWING MODIFICATIONS: INCREASE STUD DEPTH, DECREASE STUD MATERIAL THICKNESS, INCREASE STUD SPACING, INCREASE FASTENER SPACING, INCREASE INSULATION THICKNESS UP TO CAVITY DEPTH. MODIFICATIONS MUST NOT EXCEED LIMITATIONS OF FIRE RATING.