

DESIGN NO.      UL U415 UL System A

FIRE RATING:                      1 HOUR  
STC RATING:                      32 - 36  
SOUND TEST:                      ESTIMATED RANGE  
SYSTEM THICKNESS:           3-1/8" [79 MM]  
LOCATION:                           EXTERIOR  
FRAMING TYPE:                   STEEL STUD (NONLOAD-BEARING)

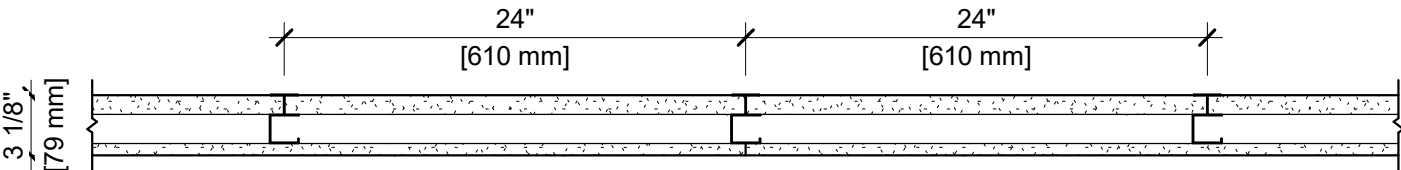

ASSEMBLY REQUIREMENTS:

GYPSUM PANELS:                      ONE LAYER 1" [25.4 MM] SHEETROCK® GYPSUM LINER PANELS (UL TYPE SLX)  
STEEL STUDS:                           2-1/2" [64 MM] CH STUDS, 25 GA. (0.018"), 24" [610 MM] O.C.  
GYPSUM PANELS:                      ONE LAYER 5/8" [15.9 MM] SECUROCK® ULTRALIGHT GLASS-MAT SHEATHING (UL TYPE USGX)

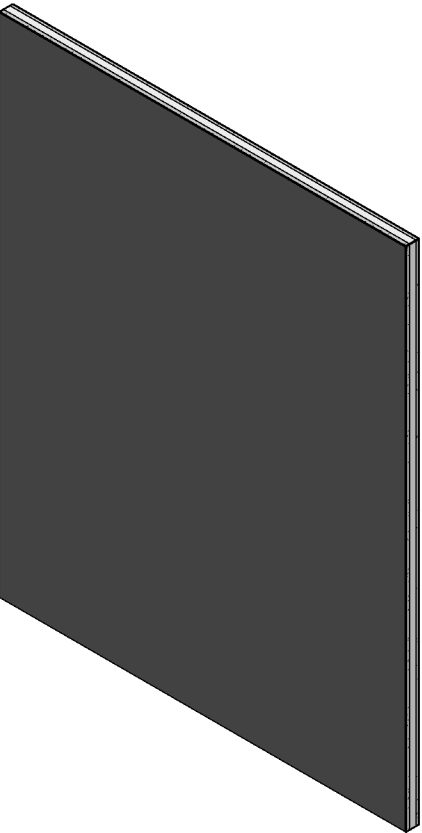

- GENERAL WALL NOTES:**
- 1. REFER TO APPLICABLE CODES REQUIREMENTS TO ENSURE COMPLIANCE PRIOR TO CONSTRUCTION.
  - 2. FOR THE MOST UP-TO-DATE DETAILS, INCLUDING CONSTRUCTION VARIATIONS, REFER TO THE PUBLISHED DESIGN.
  - 3. WHERE DESIGN NO. INDICATES "PER", THE FIRE RATING IS BASED ON LABORATORY TEST DATA OF THE REFERENCED SIMILARLY CONSTRUCTED ASSEMBLIES.
  - 4. STUD SIZES AND INSULATION THICKNESS ARE MINIMUM UNLESS OTHERWISE STATED IN THE PUBLISHED ASSEMBLY.
  - 5. STUD AND FASTENER SPACINGS ARE MAXIMUM UNLESS OTHERWISE STATED IN THE PUBLISHED ASSEMBLY.
  - 6. PANEL ORIENTATION SHALL BE AS SPECIFIED IN THE PUBLISHED DESIGN.
  - 7. FIRE-RATINGS ARE FROM BOTH SIDES UNLESS OTHERWISE STATED.
  - 8. FIRE-RATINGS ARE MAINTAINED WITH ONE OR MORE OF THE FOLLOWING MODIFICATIONS: INCREASE STUD DEPTH, INCREASE STUD MATERIAL THICKNESS, DECREASE STUD SPACING, DECREASE FASTENER SPACING, INCREASE INSULATION THICKNESS UP TO CAVITY DEPTH.
  - 9. WHERE ACOUSTICAL PERFORMANCE IS PROVIDED IN AN ESTIMATED RANGE, THE VALUES ARE BASED ON LABORATORY TEST DATA OF SIMILARLY CONSTRUCTED ASSEMBLIES.
  - 10. SOUND-RATINGS ARE MAINTAINED WITH ONE OR MORE OF THE FOLLOWING MODIFICATIONS: INCREASE STUD DEPTH, DECREASE STUD MATERIAL THICKNESS, INCREASE STUD SPACING, INCREASE FASTENER SPACING, INCREASE INSULATION THICKNESS UP TO CAVITY DEPTH. MODIFICATIONS MUST NOT EXCEED LIMITATIONS OF FIRE RATING.