

BORD FL - SUSPENSION DXT - EN COUPE DU TÉ SECONDAIRE
PANNEAU PLEIN PLAFOND AVEC PROFILÉ MURAL
RECESSED FL EDGE - DXT GRID - CROSS TEE ELEVATION

BORD FL - SUSPENSION DXT - EN COUPE DU TÉ SECONDAIRE
PANNEAU ET SECTION DE SUSPENSION COUPÉS PAR LE TÉ PRINCIPAL
RECESSED FL EDGE - DXT GRID - CROSS TEE ELEVATION

BORD FL - SUSPENSION DXT - EN COUPE DU TÉ SECONDAIRE
SUSPENSION ET PANNEAU COUPÉS AU CHANTIER AVEC PROFILÉ MURAL
RECESSED FL EDGE - DXT GRID - CROSS TEE ELEVATION

1 FULL CEILING PANEL WITH WALL ANGLE

2 PANEL AND GRID SECTION CUT THROUGH MAIN TEE

3 FULL PANEL AT WALL ANGLE

Scale: 6" = 1'-0"

Scale: 6" = 1'-0"

Scale: 6" = 1'-0"

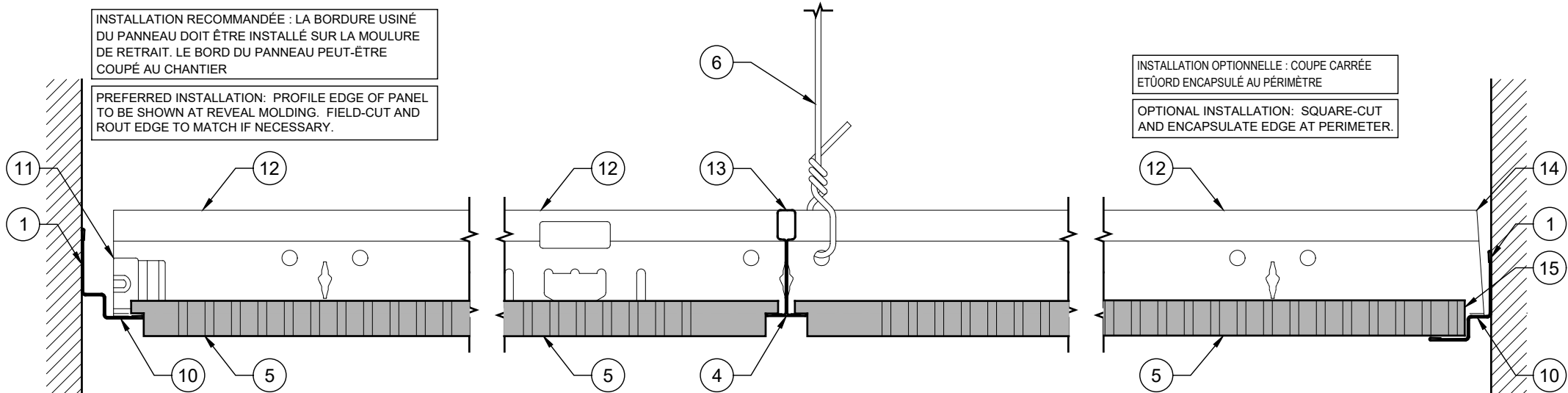

TÉ PRINCIPALE DXT AVEC EN COUPE DU TÉ PRINCIPALE
PANNEAU PLEIN PLAFOND AVEC PROFILÉ DE RETRAIT
RECESSED FL EDGE - DXT GRID - MAIN TEE ELEVATION

TÉ PRINCIPALE DXT AVEC EN COUPE DU TÉ PRINCIPALE
TÉ PRINCIPALE DXT AVEC EN COUPE DU TÉ PRINCIPALE
RECESSED FL EDGE - DXT GRID - MAIN TEE ELEVATION

TÉ PRINCIPALE DXT AVEC EN COUPE DU TÉ PRINCIPALE
SUSPENSION COUPÉ AU CHANTIER AVEC PANNEAU DE COUPÉ CARRÉE
RECESSED FL EDGE - DXT GRID - MAIN TEE ELEVATION

4 FULL CEILING PANEL WITH SHADOWLINE ANGLE

5 PANEL AND GRID SECTION CUT THROUGH CROSS TEE

6 FIELD-CUT GRID WITH SQUARE-CUT PANEL

Scale: 6" = 1'-0"

Scale: 6" = 1'-0"

Scale: 6" = 1'-0"

KEYNOTES - BASIC CEILING DETAILS
NOTAS - DETALLES BASICOS DE PLAFON
NOTES - DÉTAILS DE PLAFOND DE BASE

- 1 ATTACH WALL ANGLE AT CEILING PERIMETER.
FIJAR ANGULO PERIMETRAL AL MURO.
ATTACHEZ ANGLE MURAL AUX PÉRIMÈTRES DU PLAFOND.
- 2 WALL ANGLE.
ANGULO PERIMETRAL.
PROFILÉ MURALE.
REMOVE CLIP FROM CROSS TEE AT WALL ANGLE.
ELIMINAR EL CLIP DE LA TEE SECUNDARIA AL ANGULO PERIMETRAL.
ENLEVEZ L'ATTACHE DE TÉ SECONDAIRE À LA JONCTION DU PROFILÉ MURALE.
- 3 CROSS TEE.
TEE SECUNDARIA.
TÉ SECONDAIRE.
CEILING PANEL, USG DANOLINE LAY-IN CEILING PANEL.
PANEL DE PLAFON, USG DANOLINE LAY-IN CEILING PANEL.
PANNEAUX EN GYPSE PERFORÉS USG DANOLINE.
- 4 HANGER WIRE BY OTHERS.
ALAMBRE DE SUSPENSION (COLGANTE) POR OTROS.
FIL DE SUSPENTE PAR D'AUTRES.
- 5 SECTION CUT THROUGH MAIN TEE.
CORTE DE TEE PRINCIPAL.
SECTION COUPÉE PAR TÉ PRINCIPAL.
- 6 FIELD-CUT CROSS TEE AT WALL ANGLE.
CORTE DE TEE AL ANGULO PERIMETRAL.
COUPEZ LE TÉ SECONDAIRE À LA JONCTION DU PROFILÉ MURALE.
- 7 PANEL EDGE
BORDE DEL PANEL
BORD DU PANNEAU
- 8 SHADOW MOLDING.
ANGULO PERIMETRAL.
PROFILÉ MURALE.
- 9 REMOVE CLIP FROM MAIN TEE AT WALL ANGLE.
ELIMINAR EL CLIP DE LA TEE PRINCIPAL AL ANGULO PERIMETRAL.
ENLEVEZ L'ATTACHE DE TÉ PRINCIPAL À LA JONCTION DU PROFILÉ MURALE.
- 10 MAIN TEE.
TEE PRINCIPAL.
TÉ PRINCIPAL.
SECTION CUT THROUGH CROSS TEE.
CORTE DE TEE SECUNDARIA.
SECTION COUPÉE PAR TÉ SECONDAIRE.
- 11 FIELD-CUT MAIN TEE AT WALL ANGLE.
CORTE DE TEE PRINCIPAL AL ANGULO PERIMETRAL.
COUPEZ LE TÉ PRINCIPAL À LA JONCTION DU PROFILÉ MURALE.
- 12 SQUARE-CUT PANEL AT PERIMETER (OPTIONAL INSTALLATION).
AJUSTE EN PLAFON PERIMETRAL (INSTALACION OPCIONAL).
PANNEAU À BORD CARRÉ AU PÉRIMÈTRE (INSTALLATION FACULTATIVE).

ADDITIONAL NOTES:

1. NOT FOR CONSTRUCTION.
NO APTO PARA CONSTRUCCION.
NE PAS UTILISER POUR CONSTRUCTION.

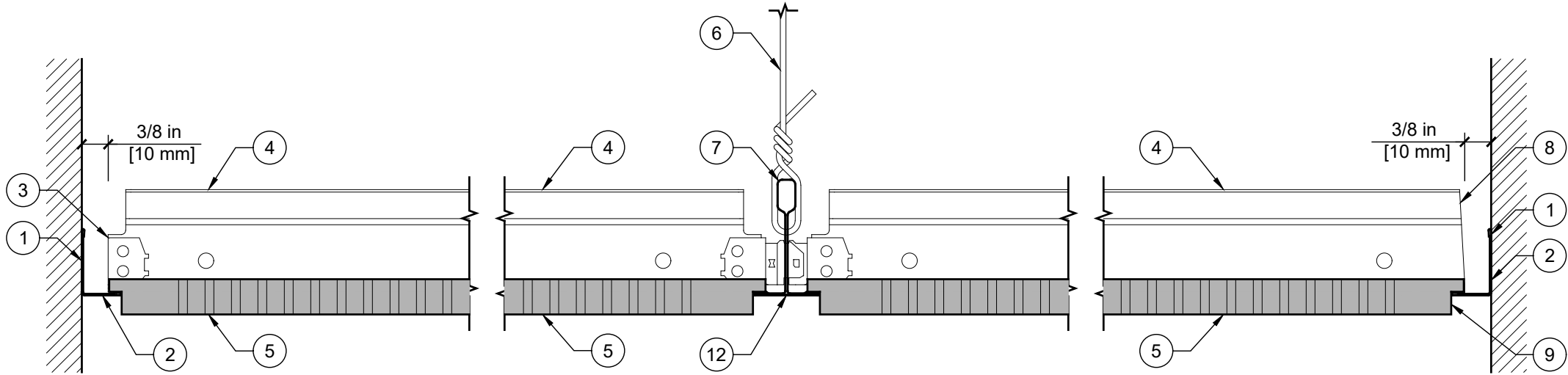

BORD SL - SUSPENSION DX - EN COUPE DU TÉ SECONDAIRE
PANNEAU PLEIN PLAFOND AVEC PROFILÉ MURAL
RECESSED SL EDGE - DX GRID - CROSS TEE ELEVATION

1 FULL CEILING PANEL WITH WALL ANGLE

Scale: 6" = 1'-0"

BORD SL - SUSPENSION DX - EN COUPE DU TÉ SECONDAIRE
PANNEAU ET SECTION DE SUSPENSION COUPÉS PAR LE TÉ PRINCIPAL
RECESSED SL EDGE - DX GRID - CROSS TEE ELEVATION

2 PANEL AND GRID SECTION CUT THROUGH MAIN TEE

Scale: 6" = 1'-0"

BORD SL - SUSPENSION DX - EN COUPE DU TÉ SECONDAIRE
SUSPENSION ET PANNEAU COUPÉS AU CHANTIER AVEC PROFILÉ MURAL
RECESSED SL EDGE - DX GRID - CROSS TEE ELEVATION

3 FULL PANEL AT WALL ANGLE

Scale: 6" = 1'-0"

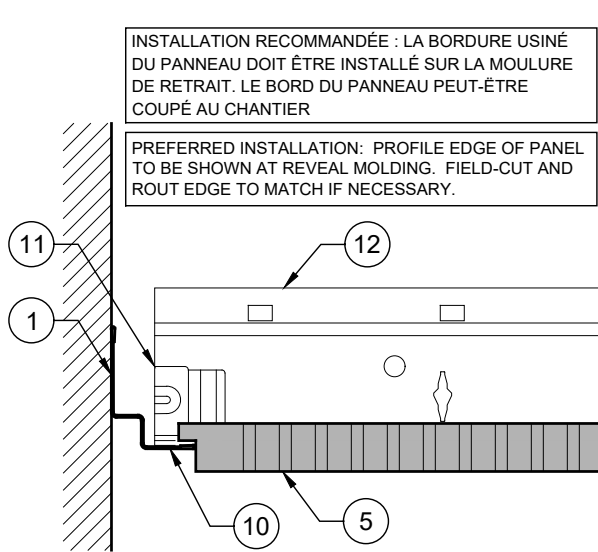

TÉ PRINCIPALE DX AVEC EN COUPE DU TÉ PRINCIPALE
PANNEAU PLEIN PLAFOND AVEC PROFILÉ DE RETRAIT
RECESSED SL EDGE - DX GRID - MAIN TEE ELEVATION

4 FULL CEILING PANEL WITH SHADOWLINE ANGLE

Scale: 6" = 1'-0"

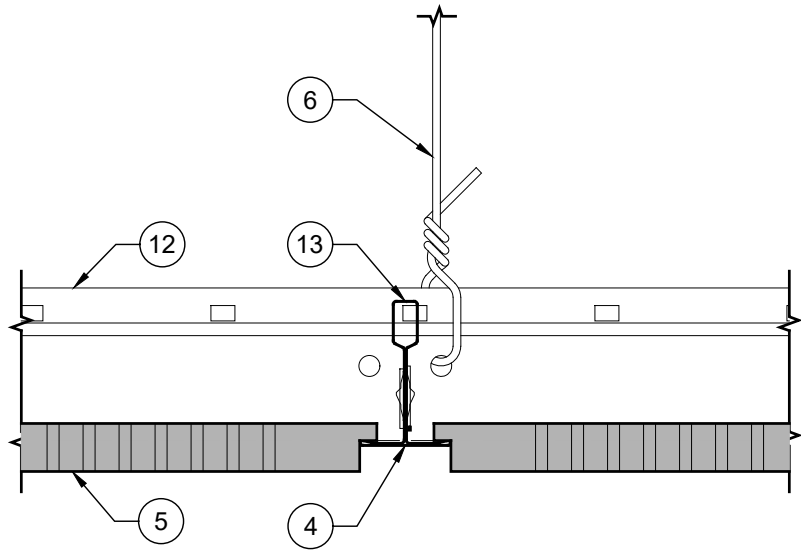

TÉ PRINCIPALE DX AVEC EN COUPE DU TÉ PRINCIPALE
TÉ PRINCIPALE DX AVEC EN COUPE DU TÉ PRINCIPALE
RECESSED SL EDGE - DX GRID - MAIN TEE ELEVATION

5 PANEL AND GRID SECTION CUT THROUGH CROSS TEE

Scale: 6" = 1'-0"

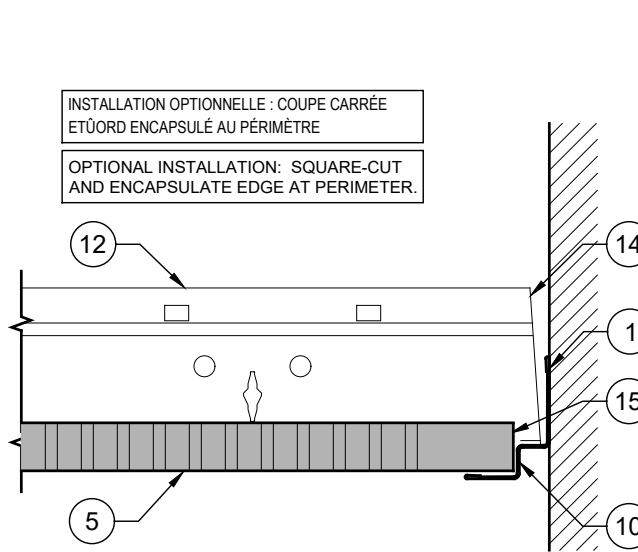

TÉ PRINCIPALE DX AVEC EN COUPE DU TÉ PRINCIPALE
SUSPENSION COUPÉ AU CHANTIER AVEC PANNEAU DE COUPÉ CARRÉE
RECESSED SL EDGE - DX GRID - MAIN TEE ELEVATION

6 FIELD-CUT GRID WITH SQUARE-CUT PANEL

Scale: 6" = 1'-0"

KEYNOTES - BASIC CEILING DETAILS NOTAS - DETALLES BASICOS DE PLAFON NOTES - DÉTAILS DE PLAFOND DE BASE

- | | |
|----|---|
| 1 | ATTACH WALL ANGLE AT CEILING PERIMETER.
FIJAR ANGULO PERIMETRAL AL MURO.
ATTACHEZ ANGLE MURAL AUX PÉRIMÈTRES DU PLAFOND. |
| 2 | WALL ANGLE.
ANGULO PERIMETRAL.
PROFILÉ MURALE. |
| 3 | REMOVE CLIP FROM CROSS TEE AT WALL ANGLE.
ELIMINAR EL CLIP DE LA TEE SECUNDARIA AL ANGULO PERIMETRAL.
ENLEVEZ L'ATTACHE DE TÉ SECONDAIRE À LA JONCTION DU PROFILÉ MURALE. |
| 4 | CROSS TEE.
TEE SECUNDARIA.
TÉ SECONDAIRE. |
| 5 | CEILING PANEL, USG DANOLINE LAY-IN CEILING PANEL.
PANEL DE PLAFON, USG DANOLINE LAY-IN CEILING PANEL.
PANNEAUX EN GYPSE PERFORÉS USG DANOLINE. |
| 6 | HANGER WIRE BY OTHERS.
ALAMBRE DE SUSPENSION (COLGANTE) POR OTROS.
FIL DE SUSPENTE PAR D'AUTRES. |
| 7 | SECTION CUT THROUGH MAIN TEE.
CORTE DE TEE PRINCIPAL.
SECTION COUPÉE PAR TÉ PRINCIPAL. |
| 8 | FIELD-CUT CROSS TEE AT WALL ANGLE.
CORTE DE TEE AL ANGULO PERIMETRAL.
COUPEZ LE TÉ SECONDAIRE À LA JONCTION DU PROFILÉ MURALE. |
| 9 | PANEL EDGE
BORDE DEL PANEL
BORD DU PANNEAU |
| 10 | SHADOW MOLDING.
ANGULO PERIMETRAL.
PROFILÉ MURALE. |
| 11 | REMOVE CLIP FROM MAIN TEE AT WALL ANGLE.
ELIMINAR EL CLIP DE LA TEE PRINCIPAL AL ANGULO PERIMETRAL.
ENLEVEZ L'ATTACHE DE TÉ PRINCIPAL À LA JONCTION DU PROFILÉ MURALE. |
| 12 | MAIN TEE.
TEE PRINCIPAL.
TÉ PRINCIPAL. |
| 13 | SECTION CUT THROUGH CROSS TEE.
CORTE DE TEE SECUNDARIA.
SECTION COUPÉE PAR TÉ SECONDAIRE. |
| 14 | FIELD-CUT MAIN TEE AT WALL ANGLE.
CORTE DE TEE PRINCIPAL AL ANGULO PERIMETRAL.
COUPEZ LE TÉ PRINCIPAL À LA JONCTION DU PROFILÉ MURALE. |
| 15 | SQUARE-CUT PANEL AT PERIMETER (OPTIONAL INSTALLATION).
AJUSTE EN PLAFON PERIMETRAL (INSTALACION OPCIONAL).
PANNEAU À BORD CARRÉ AU PÉRIMÈTRE (INSTALLATION FACULTATIVE). |

ADDITIONAL NOTES:

- NOT FOR CONSTRUCTION.
NO APTO PARA CONSTRUCCION.
NE PAS UTILISER POUR CONSTRUCTION.



USG Corporation
550 West Adams Street
Chicago, IL 60661 USA
WWW.USG.Com
T. 800-USG4YOU

DISCLAIMER: THE USG PRODUCT DETAILS CONTAINED HEREIN ARE INTENDED FOR USE AS PRODUCT REFERENCE MATERIAL BY ARCHITECTS, ENGINEERS, OTHER DESIGN PROFESSIONALS, CONTRACTORS, BUILDING CODE OFFICIALS, OR OTHER COMPETENT CONSTRUCTION INDUSTRY TRADE PROFESSIONALS HAVING AN INTEREST IN THE SELECTION, SPECIFICATION AND USE OF PRODUCTS MANUFACTURED BY THE SUBSIDIARIES OF USG CORPORATION. THE DRAWINGS ARE INTENDED SOLELY AS TECHNICAL SUPPORT INCIDENT TO THE SALE AND USE OF USG PRODUCTS AND NOT INTENDED TO BE A SUBSTITUTE FOR THE DESIGN REVIEW AND APPROVAL OF THE LICENSED DESIGN PROFESSIONALS FOR THE PROJECT. THESE MATERIALS MAY BE PRINTED AND/OR TRANSFERRED ELECTRONICALLY SOLELY AS NEEDED BY THE USER. BECAUSE CAD ELECTRONIC FILES AND BIM (BUILDING INFORMATION MODELING) FILES CAN BE MODIFIED BY OTHER PARTIES, WITHOUT NOTICE OR INDICATION OF SUCH MODIFICATIONS, MODIFICATION OF USG PRODUCT CAD DRAWINGS IS THE SOLE RESPONSIBILITY OF THE DESIGN PROFESSIONAL. ©2017 USG CORPORATION.

USG DANOLINE LAY-IN PANELS (NON SEISMIC) PLAFON USG DANOLINE (SIN RESISTENCIA SISMICA) DÉTAILS DE SUSPENSION PLAFOND DE BASE (SYSTÈME NON SISMIQUE)

ISSUE RECORD:

REV: DATE:
00 11 DEC 2019

SHEET INFORMATION:

RECESSED PANEL - SL EDGE DX GRID
PANNEAUX BORD SL - SUSPENSION DX

IC767 - 2

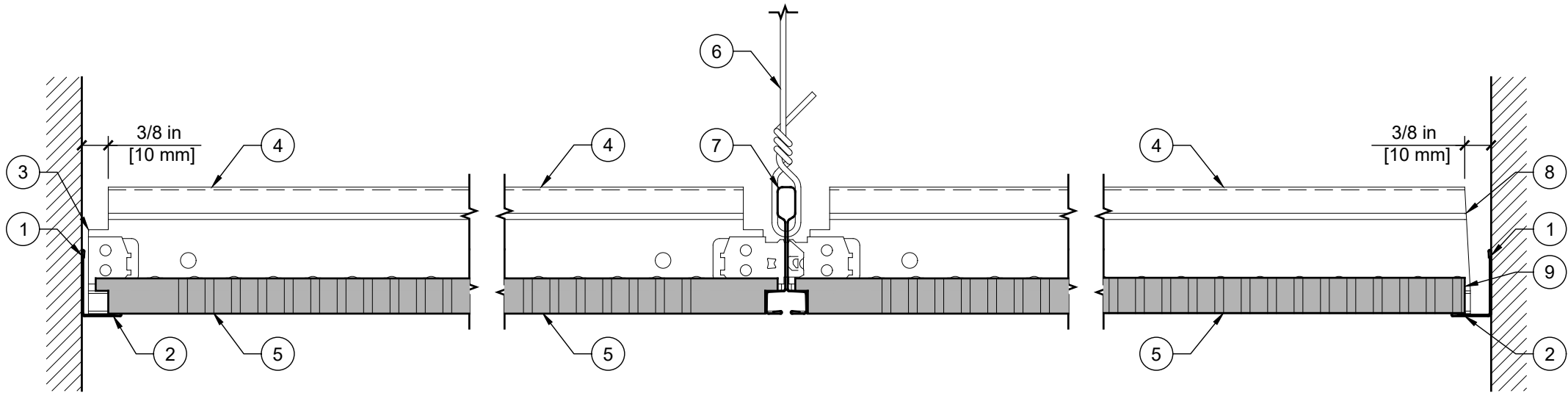

BORD FL - SUSPENSION DXFF - EN COUPE DU TÉ SECONDAIRE
PANNEAU PLEIN PLAFOND AVEC PROFILÉ MURAL
RECESSED FL EDGE - DXFF GRID - CROSS TEE ELEVATION

BORD FL - SUSPENSION DXFF - EN COUPE DU TÉ SECONDAIRE
PANNEAU ET SECTION DE SUSPENSION COUPÉS PAR LE TÉ PRINCIPAL
RECESSED FL EDGE - DXFF GRID - CROSS TEE ELEVATION

BORD FL - SUSPENSION DXFF - EN COUPE DU TÉ SECONDAIRE
SUSPENSION ET PANNEAU COUPÉS AU CHANTIER AVEC PROFILÉ MURAL
RECESSED FL EDGE - DXFF GRID - CROSS TEE ELEVATION

FULL CEILING PANEL WITH WALL ANGLE

PANEL AND GRID SECTION CUT THROUGH MAIN TEE

FIELD-CUT GRID AND PANEL AT WALL ANGLE

Scale: 6" = 1'-0"

Scale: 6" = 1'-0"

Scale: 6" = 1'-0"

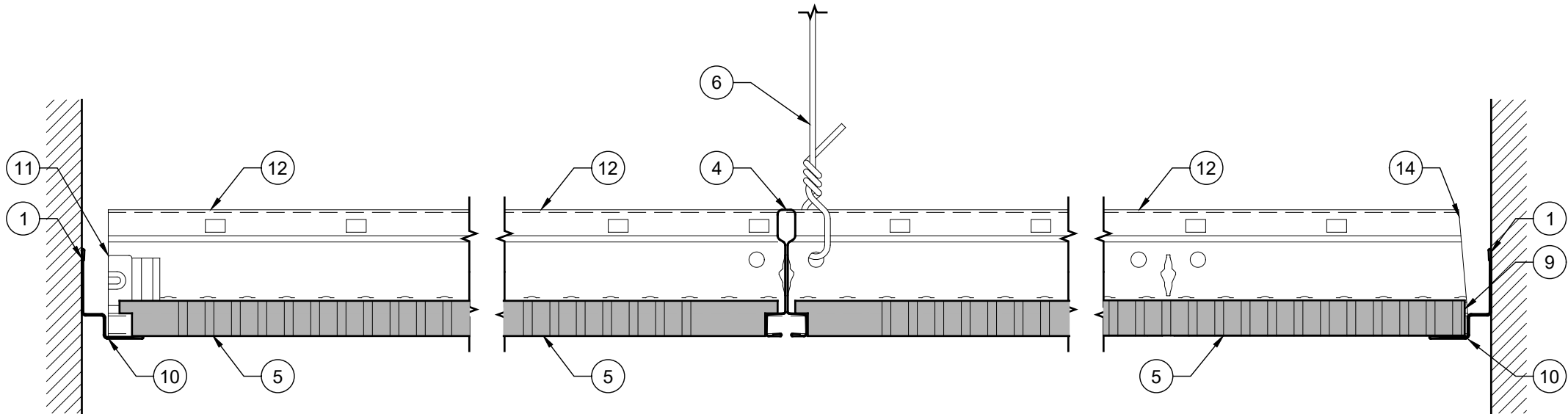

TÉ PRINCIPALE DXFF AVEC EN COUPE DU TÉ PRINCIPALE
PANNEAU PLEIN PLAFOND AVEC PROFILÉ DE RETRAIT
RECESSED FL EDGE - DXFF GRID - MAIN TEE ELEVATION

TÉ PRINCIPALE DXFF AVEC EN COUPE DU TÉ PRINCIPALE
TÉ PRINCIPALE DXFF AVEC EN COUPE DU TÉ PRINCIPALE
RECESSED FL EDGE - DXFF GRID - MAIN TEE ELEVATION

TÉ PRINCIPALE DXFF AVEC EN COUPE DU TÉ PRINCIPALE
SUSPENSION COUPÉ AU CHANTIER AVEC PANNEAU DE COUPÉ CARRÉE
RECESSED FL EDGE - DXFF GRID - MAIN TEE ELEVATION

FULL CEILING PANEL WITH SHADOWLINE ANGLE

PANEL AND GRID SECTION CUT THROUGH CROSS TEE

FIELD-CUT GRID WITH SQUARE-CUT PANEL

Scale: 6" = 1'-0"

Scale: 6" = 1'-0"

Scale: 6" = 1'-0"

KEYNOTES - BASIC CEILING DETAILS
NOTAS - DETALLES BASICOS DE PLAFON
NOTES - DÉTAILS DE PLAFOND DE BASE

- | | |
|----|---|
| 1 | ATTACH WALL ANGLE AT CEILING PERIMETER.
FIJAR ANGULO PERIMETRAL AL MURO.
ATTACHEZ ANGLE MURAL AUX PÉRIMÈTRES DU PLAFOND. |
| 2 | WALL ANGLE.
ANGULO PERIMETRAL.
PROFILÉ MURALE. |
| 3 | REMOVE CLIP FROM CROSS TEE AT WALL ANGLE.
ELIMINAR EL CLIP DE LA TEE SECUNDARIA AL ANGULO PERIMETRAL.
ENLEVEZ L'ATTACHE DE TÉ SECONDAIRE À LA JONCTION DU PROFILÉ MURALE. |
| 4 | CROSS TEE.
TEE SECUNDARIA.
TÉ SECONDAIRE. |
| 5 | CEILING PANEL, USG DANOLINE LAY-IN CEILING PANEL.
PANEL DE PLAFON, USG DANOLINE LAY-IN CEILING PANEL.
PANNEAUX EN GYPSE PERFORÉS USG DANOLINE. |
| 6 | HANGER WIRE BY OTHERS.
ALAMBRE DE SUSPENSION (COLGANTE) POR OTROS.
FIL DE SUSPENTE PAR D'AUTRES. |
| 7 | SECTION CUT THROUGH MAIN TEE.
CORTE DE TEE PRINCIPAL.
SECTION COUPÉE PAR TÉ PRINCIPAL. |
| 8 | FIELD-CUT CROSS TEE AT WALL ANGLE.
CORTE DE TEE AL ANGULO PERIMETRAL.
COUPEZ LE TÉ SECONDAIRE À LA JONCTION DU PROFILÉ MURALE. |
| 9 | PANEL EDGE
BORDE DEL PANEL
BORD DU PANNEAU |
| 10 | SHADOW MOLDING.
ANGULO PERIMETRAL.
PROFILÉ MURALE. |
| 11 | REMOVE CLIP FROM MAIN TEE AT WALL ANGLE.
ELIMINAR EL CLIP DE LA TEE PRINCIPAL AL ANGULO PERIMETRAL.
ENLEVEZ L'ATTACHE DE TÉ PRINCIPAL À LA JONCTION DU PROFILÉ MURALE. |
| 12 | MAIN TEE.
TEE PRINCIPAL.
TÉ PRINCIPAL. |
| 13 | SECTION CUT THROUGH CROSS TEE.
CORTE DE TEE SECUNDARIA.
SECTION COUPÉE PAR TÉ SECONDAIRE. |
| 14 | FIELD-CUT MAIN TEE AT WALL ANGLE.
CORTE DE TEE PRINCIPAL AL ANGULO PERIMETRAL.
COUPEZ LE TÉ PRINCIPAL À LA JONCTION DU PROFILÉ MURALE. |
| 15 | SQUARE-CUT PANEL AT PERIMETER (OPTIONAL INSTALLATION).
AJUSTE EN PLAFON PERIMETRAL (INSTALACION OPCIONAL).
PANNEAU À BORD CARRÉ AU PÉRIMÈTRE (INSTALLATION FACULTATIVE). |

ADDITIONAL NOTES:

1. NOT FOR CONSTRUCTION.
NO APTO PARA CONSTRUCCION.
NE PAS UTILISER POUR CONSTRUCTION.

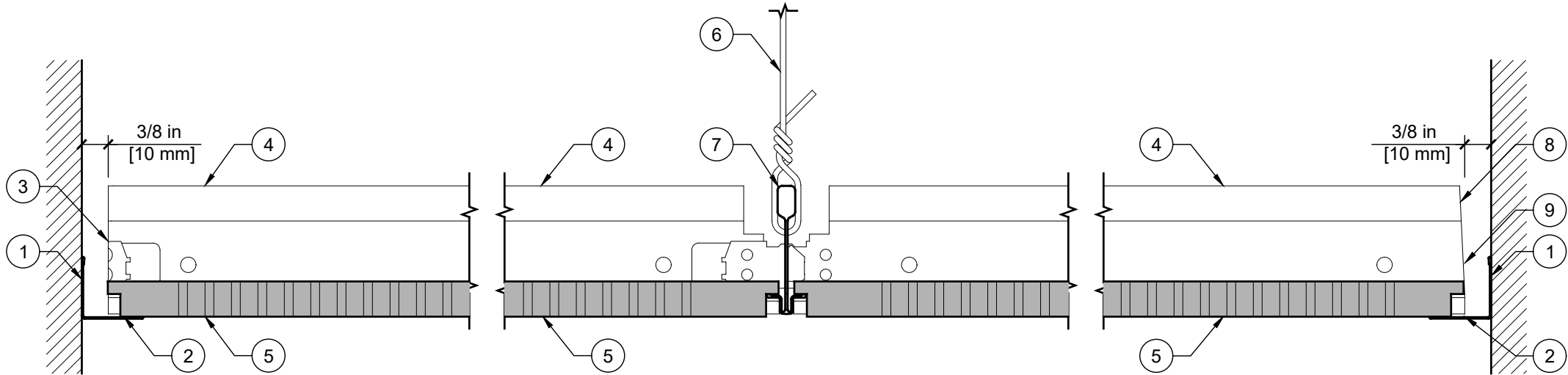

BORD FL - SUSPENSION DXI - EN COUPE DU TÉ SECONDAIRE
PANNEAU PLEIN PLAFOND AVEC PROFILÉ MURAL
RECESSED FL EDGE - DXI GRID - CROSS TEE ELEVATION

BORD FL - SUSPENSION DXI - EN COUPE DU TÉ SECONDAIRE
PANNEAU ET SECTION DE SUSPENSION COUPÉS PAR LE TÉ PRINCIPAL
RECESSED FL EDGE - DXI GRID - CROSS TEE ELEVATION

BORD FL - SUSPENSION DXI - EN COUPE DU TÉ SECONDAIRE
SUSPENSION ET PANNEAU COUPÉS AU CHANTIER AVEC PROFILÉ MURAL
RECESSED FL EDGE - DXI GRID - CROSS TEE ELEVATION

FULL CEILING PANEL WITH WALL ANGLE

PANEL AND GRID SECTION CUT THROUGH MAIN TEE

FULL PANEL AT WALL ANGLE

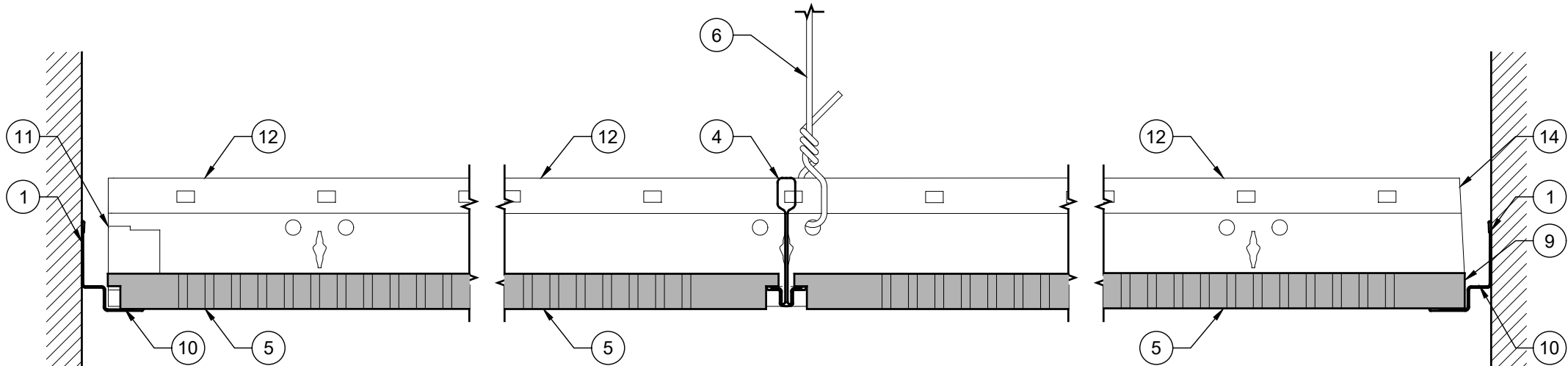

TÉ PRINCIPALE DXI AVEC EN COUPE DU TÉ PRINCIPALE
PANNEAU PLEIN PLAFOND AVEC PROFILÉ DE RETRAIT
RECESSED FL EDGE - DXI GRID - MAIN TEE ELEVATION

TÉ PRINCIPALE DXI AVEC EN COUPE DU TÉ PRINCIPALE
TÉ PRINCIPALE DXI AVEC EN COUPE DU TÉ PRINCIPALE
RECESSED FL EDGE - DXI GRID - MAIN TEE ELEVATION

TÉ PRINCIPALE DXI AVEC EN COUPE DU TÉ PRINCIPALE
SUSPENSION COUPÉ AU CHANTIER AVEC PANNEAU DE COUPÉ CARRÉE
RECESSED FL EDGE - DXI GRID - MAIN TEE ELEVATION

FULL CEILING PANEL WITH SHADOWLINE ANGLE

PANEL AND GRID SECTION CUT THROUGH CROSS TEE

FIELD-CUT GRID WITH SQUARE-CUT PANEL

KEYNOTES - BASIC CEILING DETAILS
NOTAS - DETALLES BASICOS DE PLAFON
NOTES - DÉTAILS DE PLAFOND DE BASE

- 1 ATTACH WALL ANGLE AT CEILING PERIMETER.
FIJAR ANGULO PERIMETRAL AL MURO.
ATTACHEZ ANGLE MURAL AUX PÉRIMÈTRES DU PLAFOND.
- 2 WALL ANGLE.
ANGULO PERIMETRAL.
PROFILÉ MURALE.
REMOVE CLIP FROM CROSS TEE AT WALL ANGLE.
ELIMINAR EL CLIP DE LA TEE SECUNDARIA AL ANGULO PERIMETRAL.
ENLEVEZ L'ATTACHE DE TÉ SECONDAIRE À LA JONCTION DU PROFILÉ MURALE.
- 3 CROSS TEE.
TEE SECUNDARIA.
TÉ SECONDAIRE.
CEILING PANEL, USG DANOLINE LAY-IN CEILING PANEL.
PANEL DE PLAFON, USG DANOLINE LAY-IN CEILING PANEL.
PANNEAUX EN GYPSE PERFORÉS USG DANOLINE.
- 4 HANGER WIRE BY OTHERS.
ALAMBRE DE SUSPENSION (COLGANTE) POR OTROS.
FIL DE SUSPENTE PAR D'AUTRES.
- 5 SECTION CUT THROUGH MAIN TEE.
CORTE DE TEE PRINCIPAL.
SECTION COUPÉE PAR TÉ PRINCIPAL.
- 6 FIELD-CUT CROSS TEE AT WALL ANGLE.
CORTE DE TEE AL ANGULO PERIMETRAL.
COUPEZ LE TÉ SECONDAIRE À LA JONCTION DU PROFILÉ MURALE.
- 7 PANEL EDGE
BORDE DEL PANEL
BORD DU PANNEAU
- 8 SHADOW MOLDING.
ANGULO PERIMETRAL.
PROFILÉ MURALE.
REMOVE CLIP FROM MAIN TEE AT WALL ANGLE.
ELIMINAR EL CLIP DE LA TEE PRINCIPAL AL ANGULO PERIMETRAL.
ENLEVEZ L'ATTACHE DE TÉ PRINCIPAL À LA JONCTION DU PROFILÉ MURALE.
- 9 MAIN TEE.
TEE PRINCIPAL.
TÉ PRINCIPAL.
SECTION CUT THROUGH CROSS TEE.
CORTE DE TEE SECUNDARIA.
SECTION COUPÉE PAR TÉ SECONDAIRE.
- 10 FIELD-CUT MAIN TEE AT WALL ANGLE.
CORTE DE TEE PRINCIPAL AL ANGULO PERIMETRAL.
COUPEZ LE TÉ PRINCIPAL À LA JONCTION DU PROFILÉ MURALE.
- 11 SQUARE-CUT PANEL AT PERIMETER (OPTIONAL INSTALLATION).
AJUSTE EN PLAFON PERIMETRAL (INSTALACION OPCIONAL).
PANNEAU À BORD CARRÉ AU PÉRIMÈTRE (INSTALLATION FACULTATIVE).

ADDITIONAL NOTES:

1. NOT FOR CONSTRUCTION.
NO APTO PARA CONSTRUCCION.
NE PAS UTILISER POUR CONSTRUCTION.

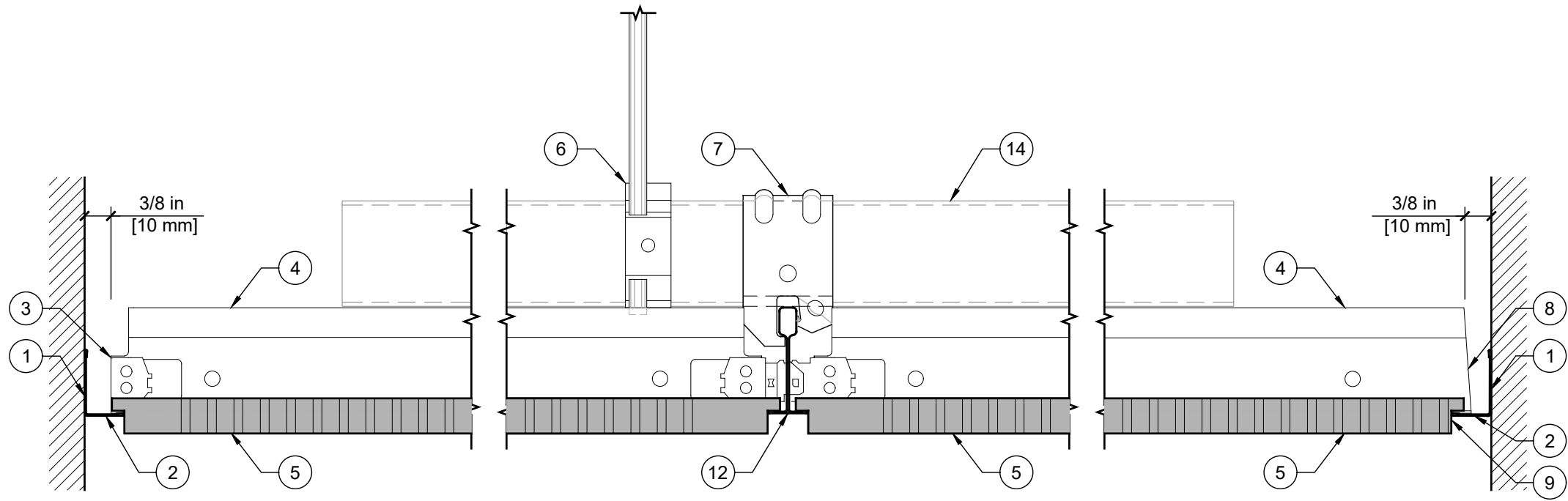

1 RECESSED FL EDGE - DXT GRID - CROSS TEE ELEVATION
FULL CEILING PANEL WITH WALL ANGLE
Scale: 6" = 1'-0"

2 RECESSED FL EDGE - DXT GRID - CROSS TEE ELEVATION
PANEL AND GRID SECTION CUT THROUGH MAIN TEE
Scale: 6" = 1'-0"

3 RECESSED FL EDGE - DXT GRID - CROSS TEE ELEVATION
FULL PANEL AT WALL ANGLE
Scale: 6" = 1'-0"

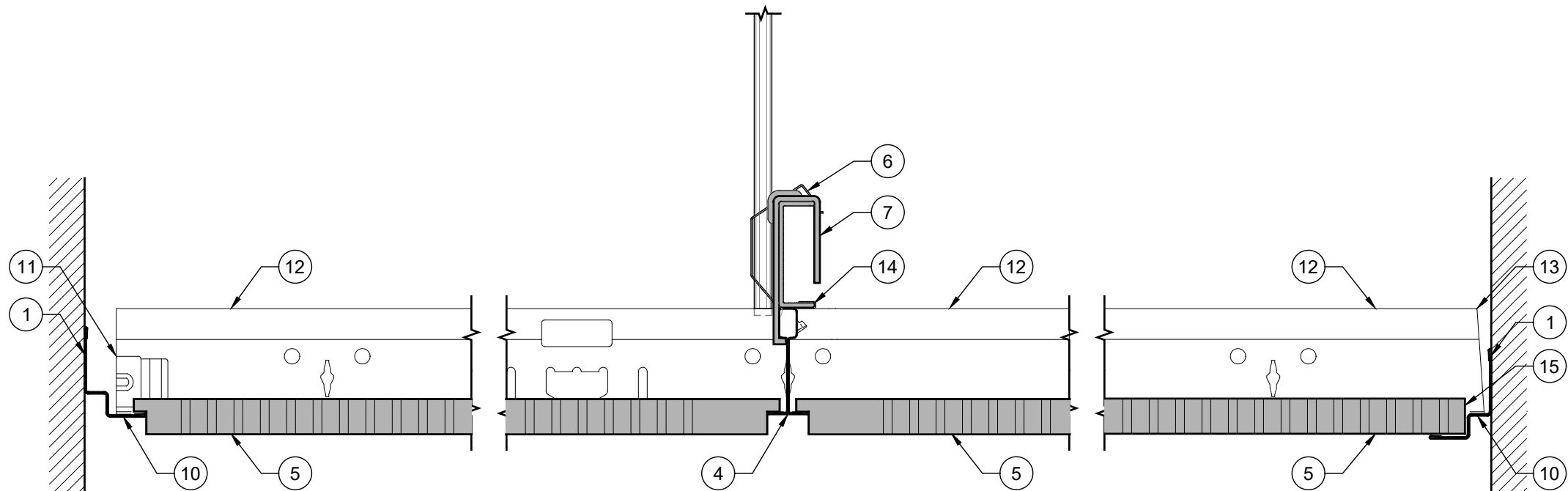

4 PREFERRED INSTALLATION: PROFILE EDGE OF PANEL TO BE SHOWN AT REVEAL MOLDING. FIELD-CUT AND ROUT EDGE TO MATCH IF NECESSARY.
RECESSED FL EDGE - DXT GRID - MAIN TEE ELEVATION
FULL CEILING PANEL WITH SHADOWLINE ANGLE
Scale: 6" = 1'-0"

5 RECESSED FL EDGE - DXT GRID - MAIN TEE ELEVATION
PANEL AND GRID SECTION CUT THROUGH CROSS TEE
Scale: 6" = 1'-0"

6 OPTIONAL INSTALLATION: SQUARE-CUT AND ENCAPSULATE EDGE AT PERIMETER.
RECESSED FL EDGE - DXT GRID - MAIN TEE ELEVATION
FIELD-CUT GRID WITH SQUARE-CUT PANEL
Scale: 6" = 1'-0"

KEYNOTES - BASIC CEILING DETAILS
NOTAS - DETALLES BASICOS DE PLAFON

- | | |
|----|---|
| 1 | ATTACH WALL ANGLE AT CEILING PERIMETER.
FIJAR ANGULO PERIMETRAL AL MURO. |
| 2 | WALL ANGLE.
ANGULO PERIMETRAL. |
| 3 | REMOVE CLIP FROM CROSS TEE AT WALL ANGLE.
ELIMINAR EL CLIP DE LA TEE SECUNDARIA AL ANGULO PERIMETRAL. |
| 4 | CROSS TEE.
TEE SECUNDARIA. |
| 5 | CEILING PANEL.
PANEL DE PLAFON. |
| 6 | STEEL HANGER ROD AND CHANNEL CLIP BY OTHERS.
VARILLA DE SUSPENSION Y CLIP DE CANAL POR OTROS. |
| 7 | ATTACH GRID TO CARRYING CHANNEL WITH USG V-14 FURRING CLIP OR EQUAL.
FIJAR SUSPENSION A CARNELTA DE CARGA CON USG V-14 CLIP O IGUAL. |
| 8 | FIELD-CUT CROSS TEE AT WALL ANGLE.
CORTE DE TEE AL ANGULO PERIMETRAL. |
| 9 | PANEL EDGE
BORDE DEL PANEL |
| 10 | SHADOW MOLDING.
ANGULO PERIMETRAL. |
| 11 | REMOVE CLIP FROM MAIN TEE AT WALL ANGLE.
ELIMINAR EL CLIP DE LA TEE PRINCIPAL AL ANGULO PERIMETRAL. |
| 12 | MAIN TEE.
TEE PRINCIPAL. |
| 13 | FIELD-CUT MAIN TEE AT WALL ANGLE.
CORTE DE TEE PRINCIPAL AL ANGULO PERIMETRAL. |
| 14 | STEEL CARRYING CHANNEL BY OTHERS.
CANAL DE CARGO POR OTROS. |
| 15 | SQUARE-CUT PANEL AT PERIMETER (OPTIONAL INSTALLATION).
AJUSTE EN PLAFON PERIMETRAL (INSTALACION OPCIONAL). |

ADDITIONAL NOTES:

1. MECHANICAL FASTENERS MAY BE REQUIRED.
CHECK WITH LOCAL CODE FOR COMPLIANCE.

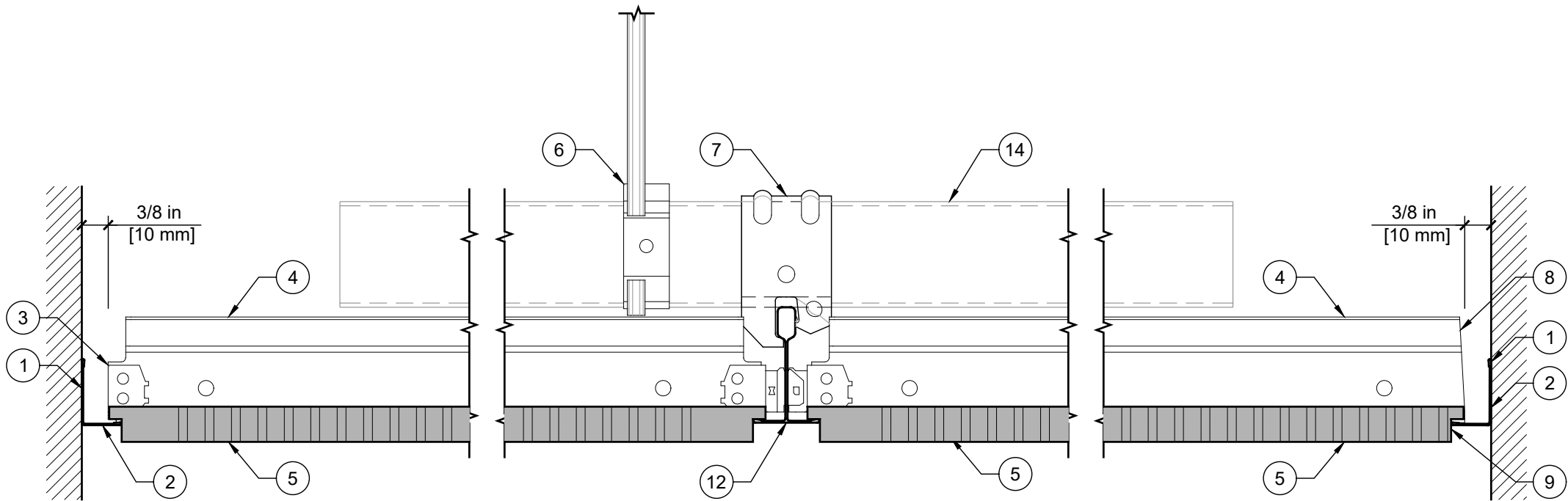

1 RECESSED SL EDGE - DX GRID - CROSS TEE ELEVATION
FULL CEILING PANEL WITH WALL ANGLE
Scale: 6" = 1'-0"

2 RECESSED SL EDGE - DX GRID - CROSS TEE ELEVATION
PANEL AND GRID SECTION CUT THROUGH MAIN TEE
Scale: 6" = 1'-0"

3 RECESSED SL EDGE - DX GRID - CROSS TEE ELEVATION
FULL PANEL AT WALL ANGLE
Scale: 6" = 1'-0"

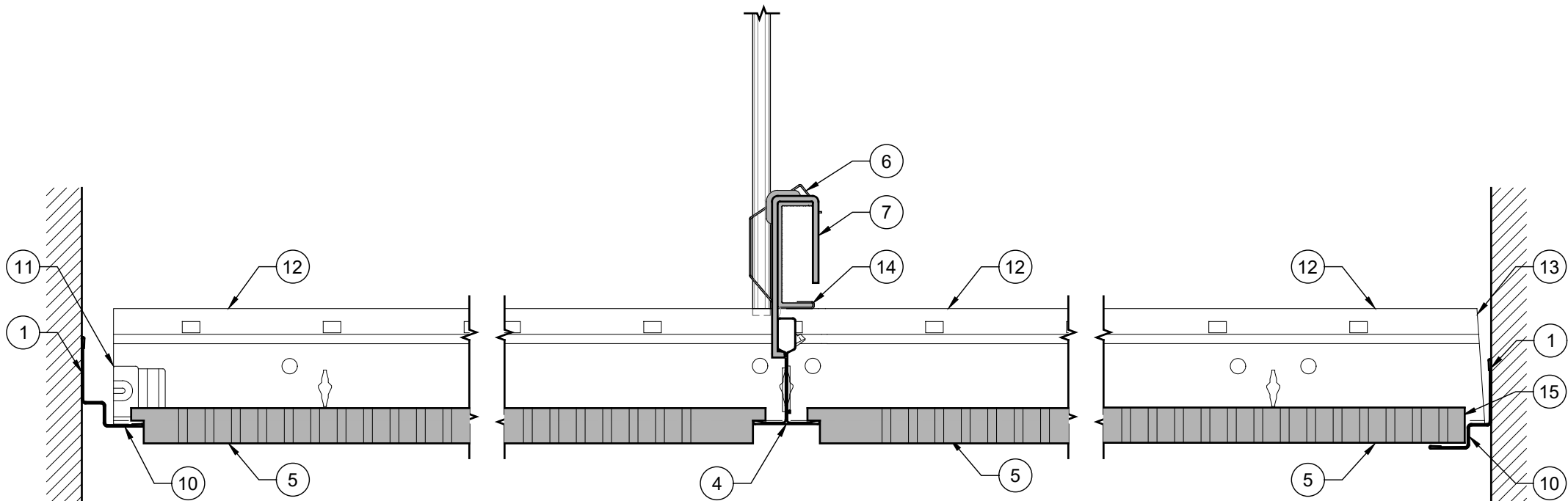

4 PREFERRED INSTALLATION: PROFILE EDGE OF PANEL TO BE SHOWN AT REVEAL MOLDING. FIELD-CUT AND ROUT EDGE TO MATCH IF NECESSARY.
RECESSED SL EDGE - DX GRID - MAIN TEE ELEVATION
FULL CEILING PANEL WITH SHADOWLINE ANGLE
Scale: 6" = 1'-0"

5 RECESSED SL EDGE - DX GRID - MAIN TEE ELEVATION
PANEL AND GRID SECTION CUT THROUGH CROSS TEE
Scale: 6" = 1'-0"

6 OPTIONAL INSTALLATION: SQUARE-CUT AND ENCAPSULATE EDGE AT PERIMETER.
RECESSED SL EDGE - DX GRID - MAIN TEE ELEVATION
FIELD-CUT GRID WITH SQUARE-CUT PANEL
Scale: 6" = 1'-0"

KEYNOTES - BASIC CEILING DETAILS
NOTAS - DETALLES BASICOS DE PLAFON

- | | |
|----|---|
| 1 | ATTACH WALL ANGLE AT CEILING PERIMETER.
FIJAR ANGULO PERIMETRAL AL MURO. |
| 2 | WALL ANGLE.
ANGULO PERIMETRAL. |
| 3 | REMOVE CLIP FROM CROSS TEE AT WALL ANGLE.
ELIMINAR EL CLIP DE LA TEE SECUNDARIA AL ANGULO PERIMETRAL. |
| 4 | CROSS TEE.
TEE SECUNDARIA. |
| 5 | CEILING PANEL.
PANEL DE PLAFON. |
| 6 | STEEL HANGER ROD AND CHANNEL CLIP BY OTHERS.
VARILLA DE SUSPENSION Y CLIP DE CANAL POR OTROS. |
| 7 | ATTACH GRID TO CARRYING CHANNEL WITH USG V-14 FURRING CLIP OR EQUAL.
FIJAR SUSPENSION A CARNELTA DE CARGA CON USG V-14 CLIP O IGUAL. |
| 8 | FIELD-CUT CROSS TEE AT WALL ANGLE.
CORTE DE TEE AL ANGULO PERIMETRAL. |
| 9 | PANEL EDGE
BORDE DEL PANEL |
| 10 | SHADOW MOLDING.
ANGULO PERIMETRAL. |
| 11 | REMOVE CLIP FROM MAIN TEE AT WALL ANGLE.
ELIMINAR EL CLIP DE LA TEE PRINCIPAL AL ANGULO PERIMETRAL. |
| 12 | MAIN TEE.
TEE PRINCIPAL. |
| 13 | FIELD-CUT MAIN TEE AT WALL ANGLE.
CORTE DE TEE PRINCIPAL AL ANGULO PERIMETRAL. |
| 14 | STEEL CARRYING CHANNEL BY OTHERS.
CANAL DE CARGO POR OTROS. |
| 15 | SQUARE-CUT PANEL AT PERIMETER (OPTIONAL INSTALLATION).
AJUSTE EN PLAFON PERIMETRAL (INSTALACION OPCIONAL). |

ADDITIONAL NOTES:

1. MECHANICAL FASTENERS MAY BE REQUIRED.
CHECK WITH LOCAL CODE FOR COMPLIANCE.

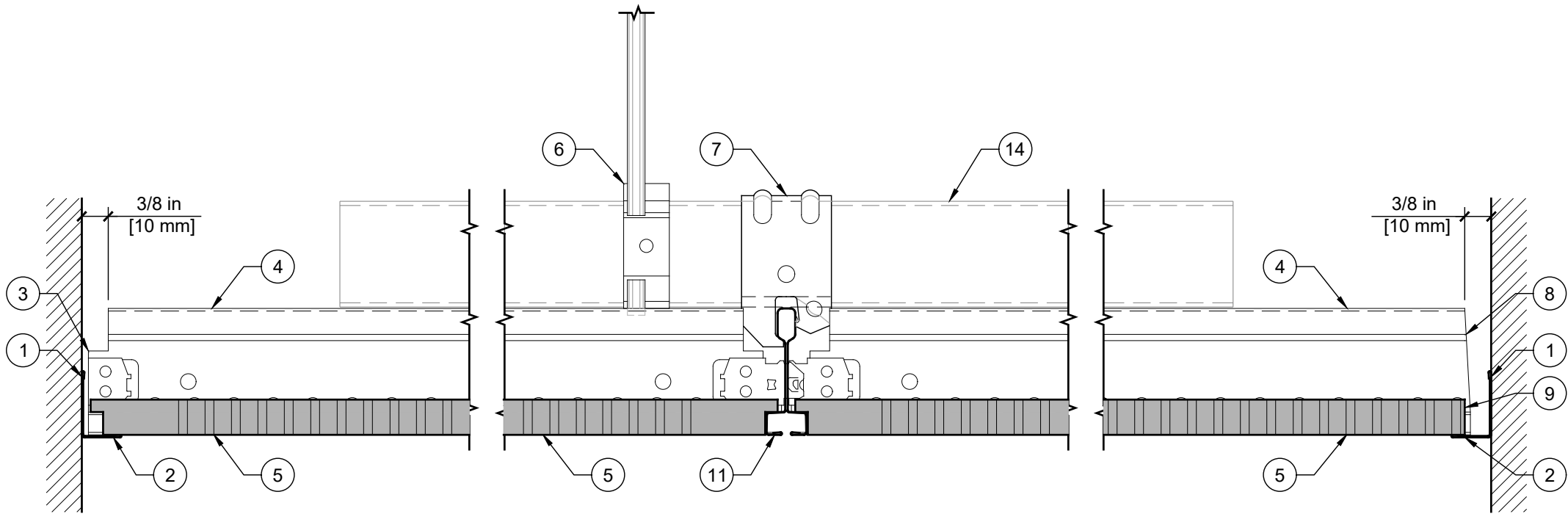

1 RECESSED FL EDGE - DXFF GRID - CROSS TEE ELEVATION
FULL CEILING PANEL WITH WALL ANGLE
Scale: 6" = 1'-0"

2 RECESSED FL EDGE - DXFF GRID - CROSS TEE ELEVATION
PANEL AND GRID SECTION CUT THROUGH MAIN TEE
Scale: 6" = 1'-0"

3 RECESSED FL EDGE - DXFF GRID - CROSS TEE ELEVATION
FIELD-CUT GRID AND PANEL AT WALL ANGLE
Scale: 6" = 1'-0"

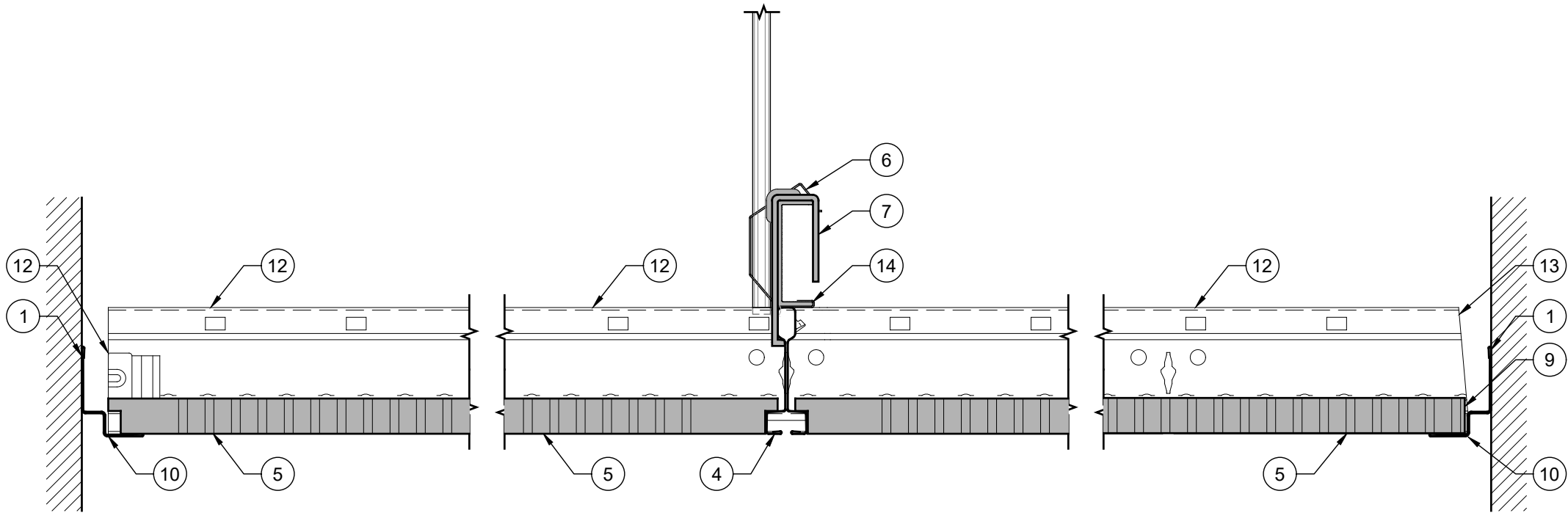

4 RECESSED FL EDGE - DXFF GRID - MAIN TEE ELEVATION
FULL CEILING PANEL WITH SHADOWLINE ANGLE
Scale: 6" = 1'-0"

5 RECESSED FL EDGE - DXFF GRID - MAIN TEE ELEVATION
PANEL AND GRID SECTION CUT THROUGH CROSS TEE
Scale: 6" = 1'-0"

6 RECESSED FL EDGE - DXFF GRID - MAIN TEE ELEVATION
FIELD-CUT GRID WITH SQUARE-CUT PANEL
Scale: 6" = 1'-0"

KEYNOTES - BASIC CEILING DETAILS
NOTAS - DETALLES BASICOS DE PLAFON

1	ATTACH WALL ANGLE AT CEILING PERIMETER. FIJAR ANGULO PERIMETRAL AL MURO.
2	WALL ANGLE. ANGULO PERIMETRAL.
3	REMOVE CLIP FROM CROSS TEE AT WALL ANGLE. ELIMINAR EL CLIP DE LA TEE SECUNDARIA AL ANGULO PERIMETRAL.
4	CROSS TEE. TEE SECUNDARIA.
5	CEILING PANEL. PANEL DE PLAFON.
6	STEEL HANGER ROD AND CHANNEL CLIP BY OTHERS. VARILLA DE SUSPENSION Y CLIP DE CANAL POR OTROS.
7	ATTACH GRID TO CARRYING CHANNEL WITH USG V-14 FURRING CLIP OR EQUAL. FIJAR SUSPENSION A CARNELTA DE CARGA CON USG V-14 CLIP O IGUAL.
8	FIELD-CUT CROSS TEE AT WALL ANGLE. CORTE DE TEE AL ANGULO PERIMETRAL.
9	PANEL EDGE BORDE DEL PANEL
10	SHADOW MOLDING. ANGULO PERIMETRAL.
11	REMOVE CLIP FROM MAIN TEE AT WALL ANGLE. ELIMINAR EL CLIP DE LA TEE PRINCIPAL AL ANGULO PERIMETRAL.
12	MAIN TEE. TEE PRINCIPAL.
13	FIELD-CUT MAIN TEE AT WALL ANGLE. CORTE DE TEE PRINCIPAL AL ANGULO PERIMETRAL.
14	STEEL CARRYING CHANNEL BY OTHERS. CANAL DE CARGO POR OTROS.
15	SQUARE-CUT PANEL AT PERIMETER (OPTIONAL INSTALLATION). AJUSTE EN PLAFON PERIMETRAL (INSTALACION OPCIONAL).

ADDITIONAL NOTES:

1. MECHANICAL FASTENERS MAY BE REQUIRED.
CHECK WITH LOCAL CODE FOR COMPLIANCE.

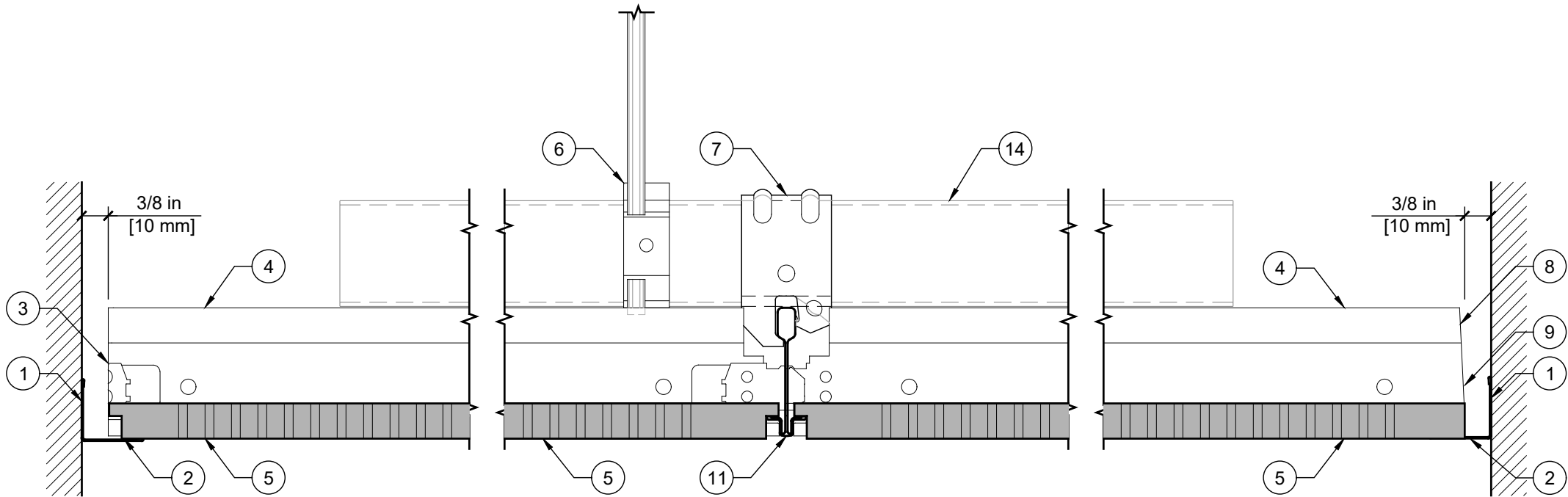

1 RECESSED FL EDGE - DXI GRID - CROSS TEE ELEVATION
FULL CEILING PANEL WITH WALL ANGLE
Scale: 6" = 1'-0"

2 RECESSED FL EDGE - DXI GRID - CROSS TEE ELEVATION
PANEL AND GRID SECTION CUT THROUGH MAIN TEE
Scale: 6" = 1'-0"

3 RECESSED FL EDGE - DXI GRID - CROSS TEE ELEVATION
FIELD-CUT GRID AND PANEL AT WALL ANGLE
Scale: 6" = 1'-0"

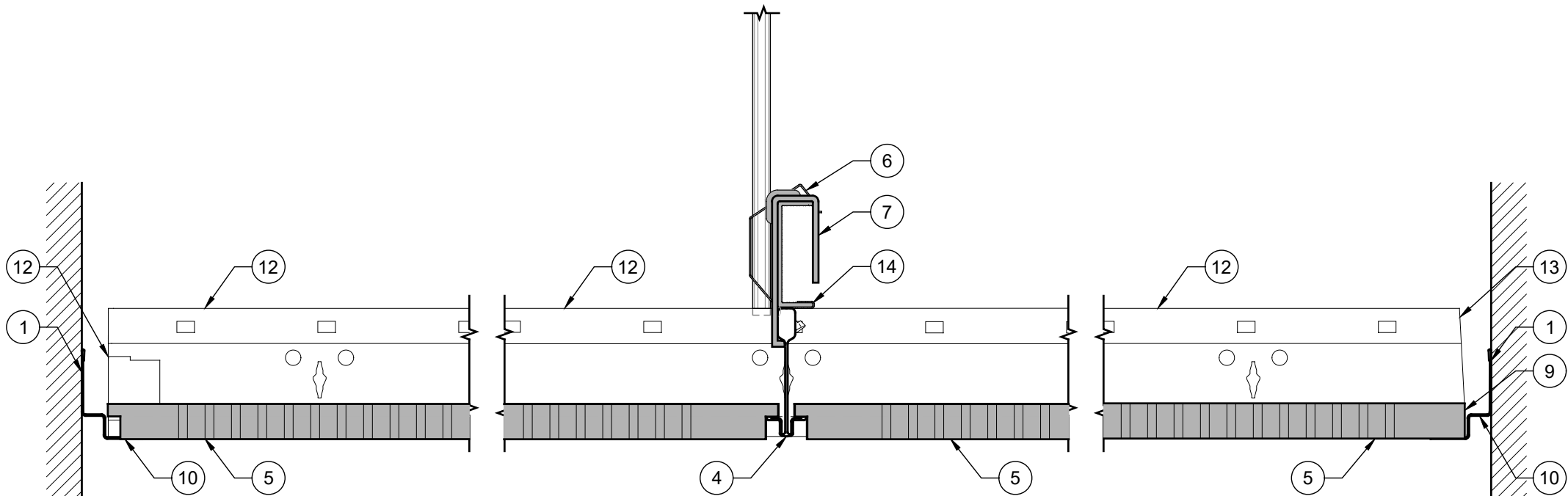

4 RECESSED FL EDGE - DXI GRID - MAIN TEE ELEVATION
FULL CEILING PANEL WITH SHADOWLINE ANGLE
Scale: 6" = 1'-0"

5 RECESSED FL EDGE - DXI GRID - MAIN TEE ELEVATION
PANEL AND GRID SECTION CUT THROUGH CROSS TEE
Scale: 6" = 1'-0"

6 RECESSED FL EDGE - DXI GRID - MAIN TEE ELEVATION
FIELD-CUT GRID WITH SQUARE-CUT PANEL
Scale: 6" = 1'-0"

KEYNOTES - BASIC CEILING DETAILS
NOTAS - DETALLES BASICOS DE PLAFON

1	ATTACH WALL ANGLE AT CEILING PERIMETER. FIJAR ANGULO PERIMETRAL AL MURO.
2	WALL ANGLE. ANGULO PERIMETRAL.
3	REMOVE CLIP FROM CROSS TEE AT WALL ANGLE. ELIMINAR EL CLIP DE LA TEE SECUNDARIA AL ANGULO PERIMETRAL.
4	CROSS TEE. TEE SECUNDARIA.
5	CEILING PANEL. PANEL DE PLAFON.
6	STEEL HANGER ROD AND CHANNEL CLIP BY OTHERS. VARILLA DE SUSPENSION Y CLIP DE CANAL POR OTROS.
7	ATTACH GRID TO CARRYING CHANNEL WITH USG V-14 FURRING CLIP OR EQUAL. FIJAR SUSPENSION A CARNELTA DE CARGA CON USG V-14 CLIP O IGUAL.
8	FIELD-CUT CROSS TEE AT WALL ANGLE. CORTE DE TEE AL ANGULO PERIMETRAL.
9	PANEL EDGE BORDE DEL PANEL
10	SHADOW MOLDING. ANGULO PERIMETRAL.
11	REMOVE CLIP FROM MAIN TEE AT WALL ANGLE. ELIMINAR EL CLIP DE LA TEE PRINCIPAL AL ANGULO PERIMETRAL.
12	MAIN TEE. TEE PRINCIPAL.
13	FIELD-CUT MAIN TEE AT WALL ANGLE. CORTE DE TEE PRINCIPAL AL ANGULO PERIMETRAL.
14	STEEL CARRYING CHANNEL BY OTHERS. CANAL DE CARGO POR OTROS.
15	SQUARE-CUT PANEL AT PERIMETER (OPTIONAL INSTALLATION). AJUSTE EN PLAFON PERIMETRAL (INSTALACION OPCIONAL).

ADDITIONAL NOTES:

1. MECHANICAL FASTENERS MAY BE REQUIRED.
CHECK WITH LOCAL CODE FOR COMPLIANCE.