

UL DESIGN NO. U408 (EXTERIOR WALL)

FIRE RATING: 2 HOUR  
STC: N/A  
SOUND TEST: N/A  
SYSTEM THICKNESS: 6"

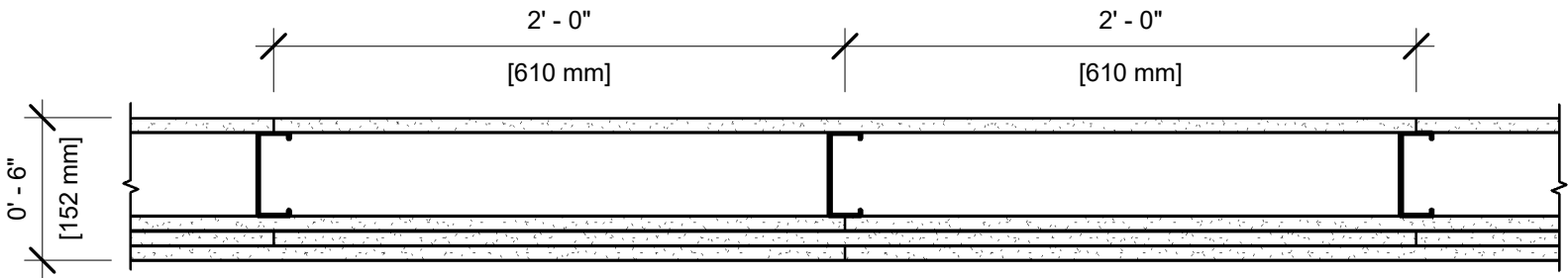

ASSEMBLY OPTIONS:

- GYPSUM BOARD: ONE LAYER 5/8" THICK GYPSUM BOARD (UL TYPE USGX™)
- STEEL STUDS: 3-1/2" STEEL STUDS, 20 GA. MSG., SPACED 24" MAX. O.C.
- GYPSUM BOARD: THREE LAYERS 5/8" THICK GYPSUM BOARD (UL TYPE ULIX™)

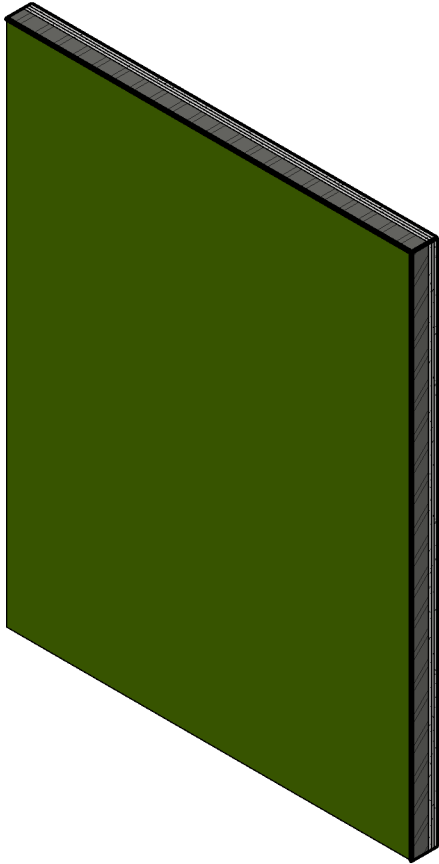

NOTES:

STUD AND INSULATION SIZES ARE MINIMUM UNLESS OTHERWISE STATED IN DESIGN.

FOR THE MOST UP-TO-DATE INFORMATION OR ASSEMBLY OPTIONS, REFER TO THE UL FIRE RESISTANCE DIRECTORY.

UL TYPE ULIX™ REQUIRES THE USE OF INSULATION FOR SINGLE-LAYER, STEEL-FRAMED UL FIRE-RATED ASSEMBLIES.

REFER TO THE UL FIRE RESISTANCE DIRECTORY FOR INFORMATION REGARDING PRODUCT ORIENTATION AND FASTENING REQUIREMENTS.