

3 HOUR CONTROL JOINT

NOTE: THIS DETAIL REPRESENTS A TYPICAL CONTROL JOINT CONSTRUCTION. REFERENCE THE PUBLISHED DESIGN CRITERIA FOR PANEL, FRAMING AND OTHER CONSTRUCTION REQUIREMENTS.

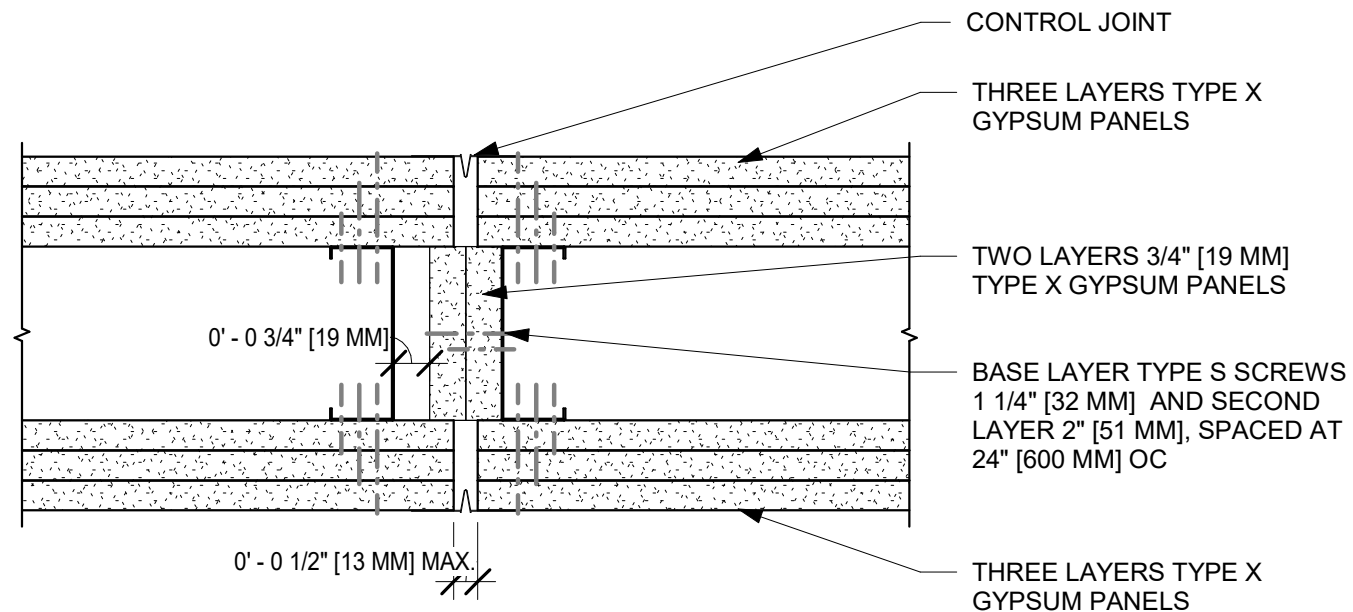

USG Corporation
550 West Adams Street, Chicago, IL 60661
T. 800-USG4YOU www.USG.com

TYPICAL CONTROL JOINT GYPSUM ASSEMBLY DETAIL

ISSUE RECORD:
10/20/20

ISSUE: DATE:

SHEET INFORMATION:

WD-CJ-S-3
STEEL STUDS, 3 HR PARTITION