

UL DESIGN NO. G556

FIRE RATING: 2 HOUR
STC: N/A
SOUND TEST: N/A
SYSTEM THICKNESS: VARIES

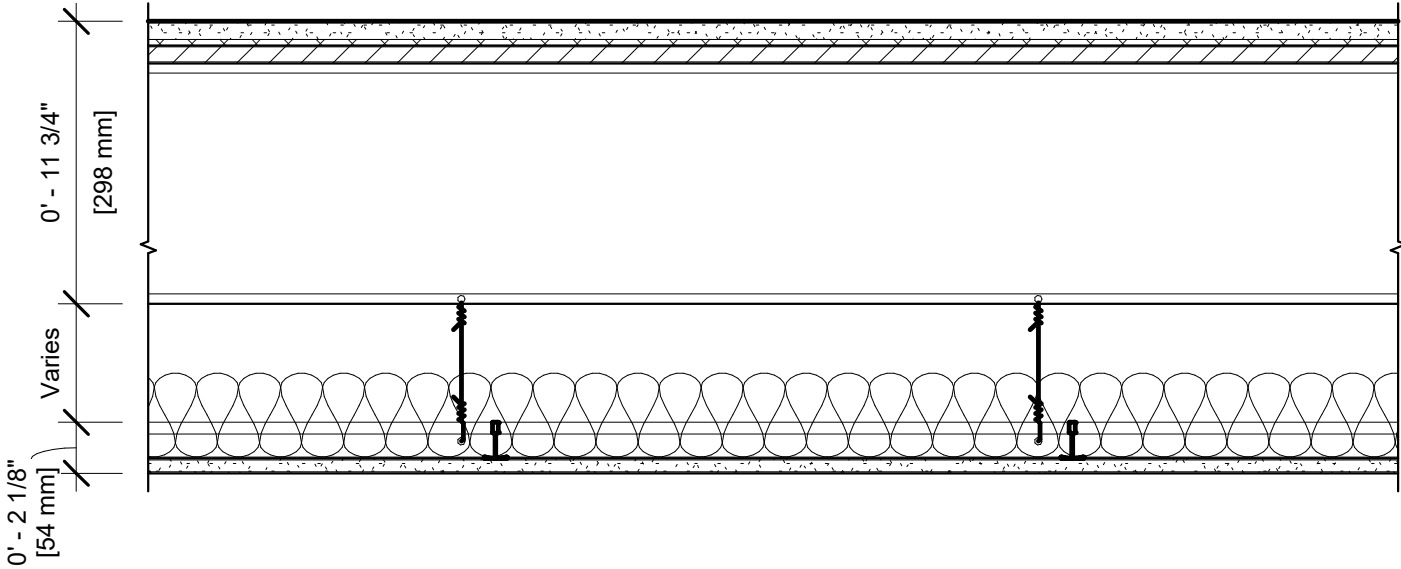

ASSEMBLY OPTIONS:

- FLOOR TOPPING MIXTURE:3/4" THICK MIN. FLOOR TOPPING, 2500 PSI (UL TYPES LRK, HSLRK, CSD)
- FLOOR MAT MATERIALS (OPTIONAL):1/4" SOUND REDUCTION MAT
- STRUCTURAL CEMENT-FIBER UNITS:3/4" USG STRUCTURAL PANEL CONCRETE SUBFLOOR (UL TYPE USGSP)
- STEEL JOISTS:CHANNEL-SHAPED, 10" DEEP MIN., 16 GA., SPACED 24" MAX. O.C.
- CLIP ANGLES (NOT SHOWN):ONE CLIP ANGLE PER JOIST END
- JOIST BRIDGING (NOT SHOWN):V-BRACING OF 1-1/2", 20 GA. GALVANIZED STEEL BETWEEN CHANNELS
- BATTS AND BLANKETS:3-5/8" THICK GLASS FIBER BATT INSULATION
- STEEL FRAMING MEMBERS:

SUSPENSION SYSTEM MAY BE USED IN LIEU OF THE RESILIENT CHANNELS. MAIN RUNNERS, CROSS TEES, CROSS CHANNELS AND WALL ANGLE AS LISTED BELOW (UL TYPE DGL):
 - MAIN RUNNERS:4' O.C. MAIN RUNNERS SUSPENDED BY 12 GA. MIN. HANGER WIRES
 - CROSS TEES:16" O.C.
 - CROSS CHANNELS:16" O.C.
 - WALL ANGLE OR CHANNEL:PAINTED OR GALVANIZED STEEL ANGLE TO SUPPORT STEEL FRAMING MEMBER ENDS AND FOR SCREW-ATTACHMENT OF THE GYPSUM PANEL
- GYPSUM BOARD:ONE LAYER 5/8" USG SHEETROCK® BRAND ECOSMART PANELS FIRECODE® X (UL TYPE ULIX™)

Revit Sytem Family
(Copy & Paste into your Revit Project)

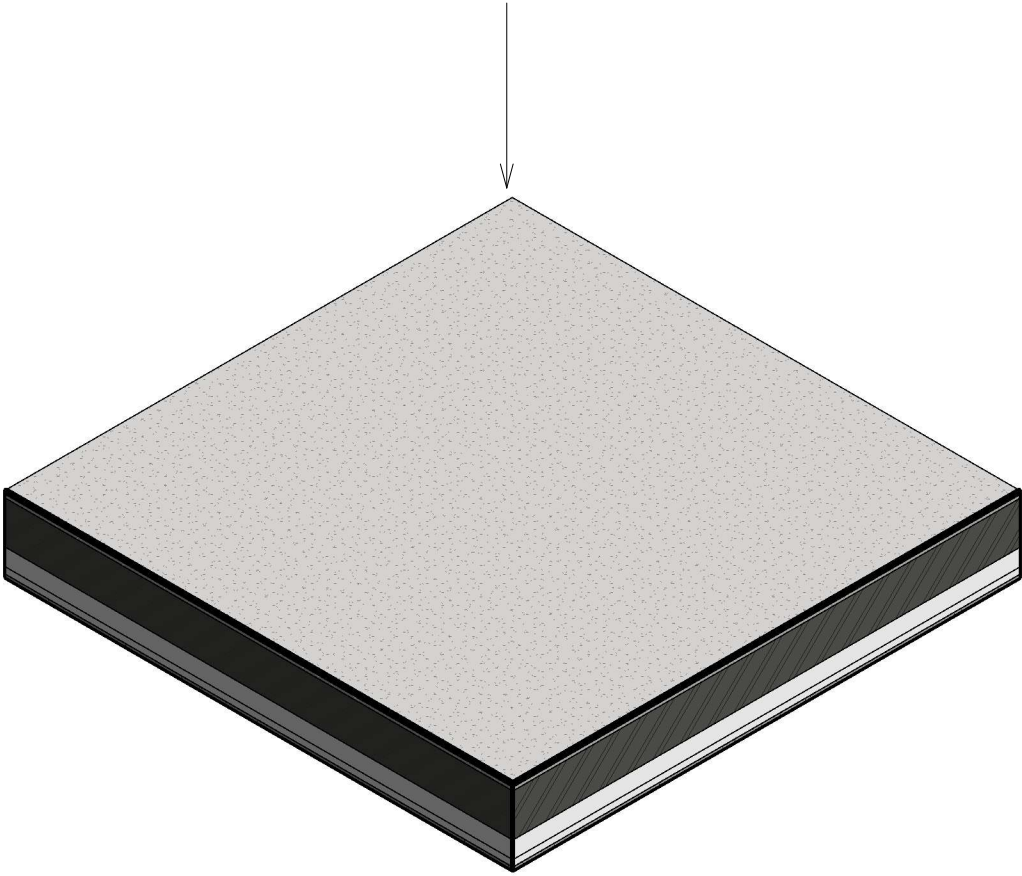

NOTES:

FOR THE MOST UP-TO-DATE INFORMATION OR ASSEMBLY OPTIONS, REFER TO THE UL FIRE RESISTANCE DIRECTORY.

REFER TO THE UL FIRE RESISTANCE DIRECTORY FOR INFORMATION REGARDING BOARD AND PANEL ORIENTATION AND FASTENING REQUIREMENTS.