

1 HOUR PARTITION

NOTE: THIS DETAIL DEPICTS A TYPICAL CORNER CONSTRUCTION. REFER TO THE PUBLISHED DESIGN FOR PANEL, FRAMING AND OTHER CONSTRUCTION REQUIREMENTS.

FINISH JOINT, AS REQUIRED

TYPE X GYPSUM PANELS

TYPE X GYPSUM PANELS

FINISH JOINT, AS REQUIRED



USG Corporation
 550 West Adams Street
 Chicago, IL 60661
 T. 800-USG4YOU

CORNER DETAIL - STEEL STUD - 1HR

ISSUE RECORD:	
06/12/20	

SHEET INFORMATION:

WD-0001-A

1 HOUR PARTITION

NOTE: THIS DETAIL DEPICTS A TYPICAL CORNER CONSTRUCTION. REFER TO THE PUBLISHED DESIGN FOR PANEL, FRAMING AND OTHER CONSTRUCTION REQUIREMENTS.

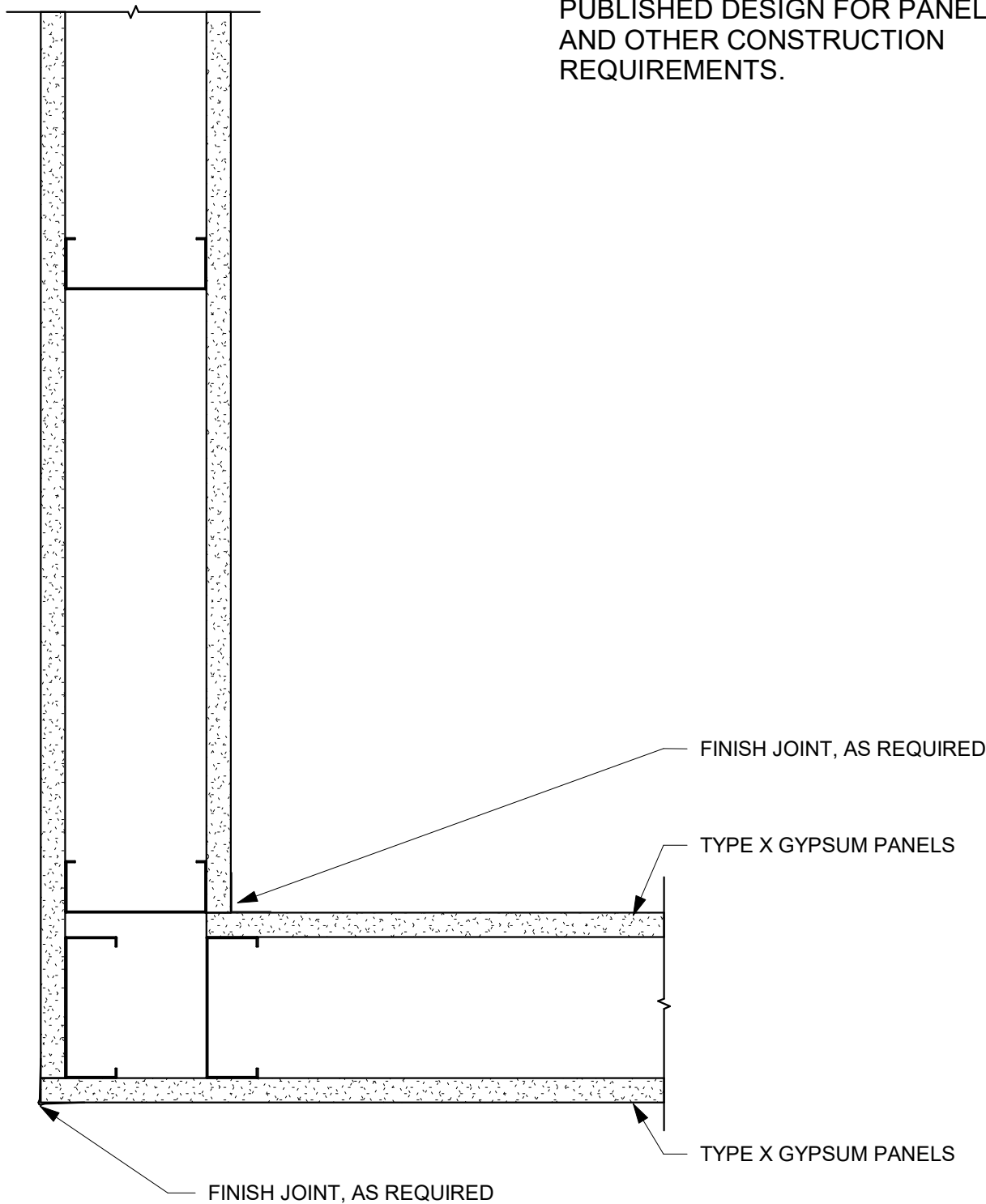

USG Corporation
550 West Adams Street
Chicago, IL 60661
T. 800-USG4YOU

CORNER DETAIL - STEEL STUD - 1HR

ISSUE RECORD:
06/12/20

SHEET INFORMATION:

WD-0001-B

2 HOUR PARTITION

NOTE: THIS DETAIL DEPICTS A TYPICAL CORNER CONSTRUCTION. REFER TO THE PUBLISHED DESIGN FOR PANEL, FRAMING AND OTHER CONSTRUCTION REQUIREMENTS.

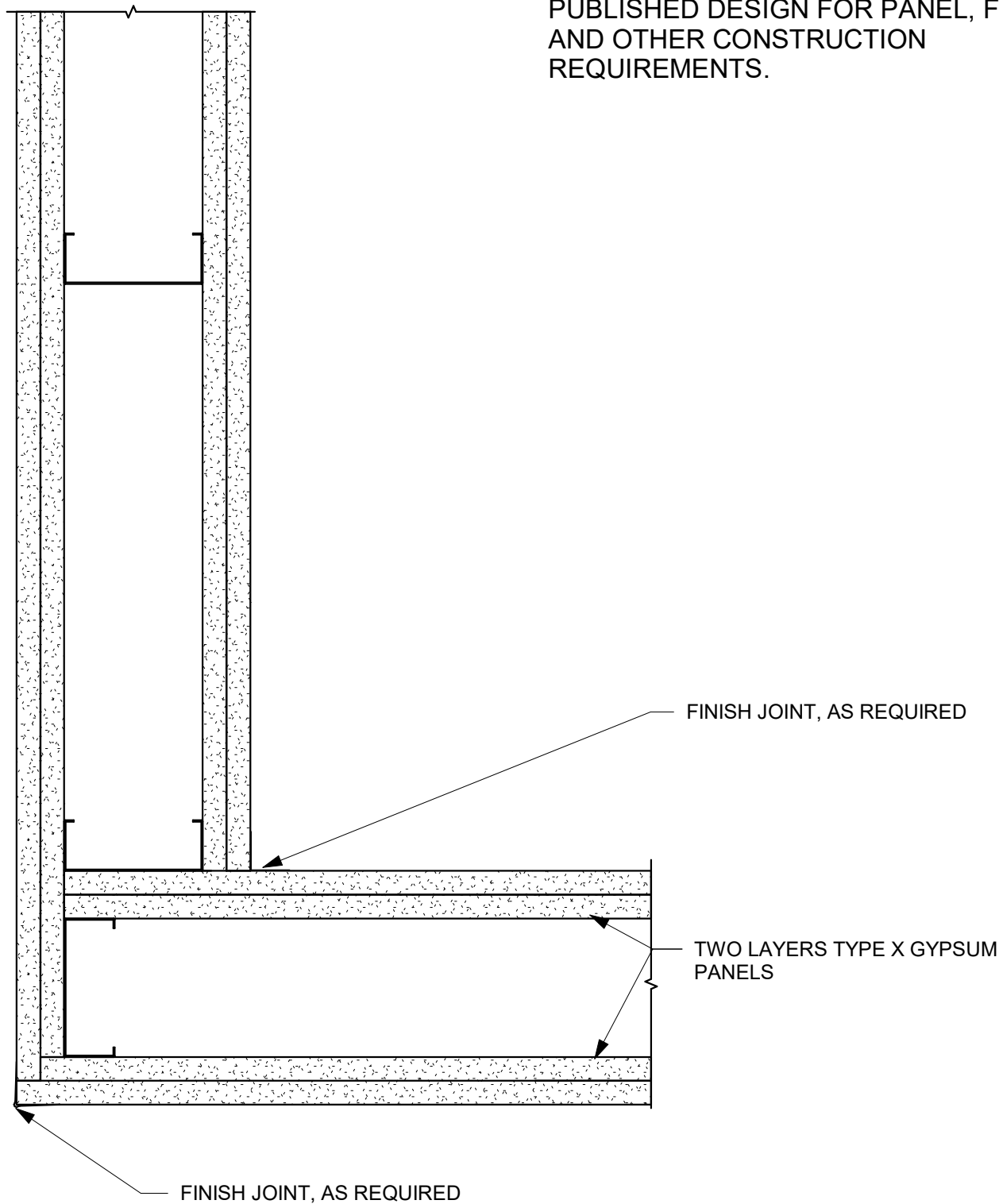

USG Corporation
550 West Adams Street
Chicago, IL 60661
T. 800-USG4YOU

CORNER DETAIL - STEEL STUD - 2HR

ISSUE RECORD:
06/12/20

SHEET INFORMATION:
WD-0001-C

2 HOUR PARTITION

NOTE: THIS DETAIL DEPICTS A TYPICAL CORNER CONSTRUCTION. REFER TO THE PUBLISHED DESIGN FOR PANEL, FRAMING AND OTHER CONSTRUCTION REQUIREMENTS.

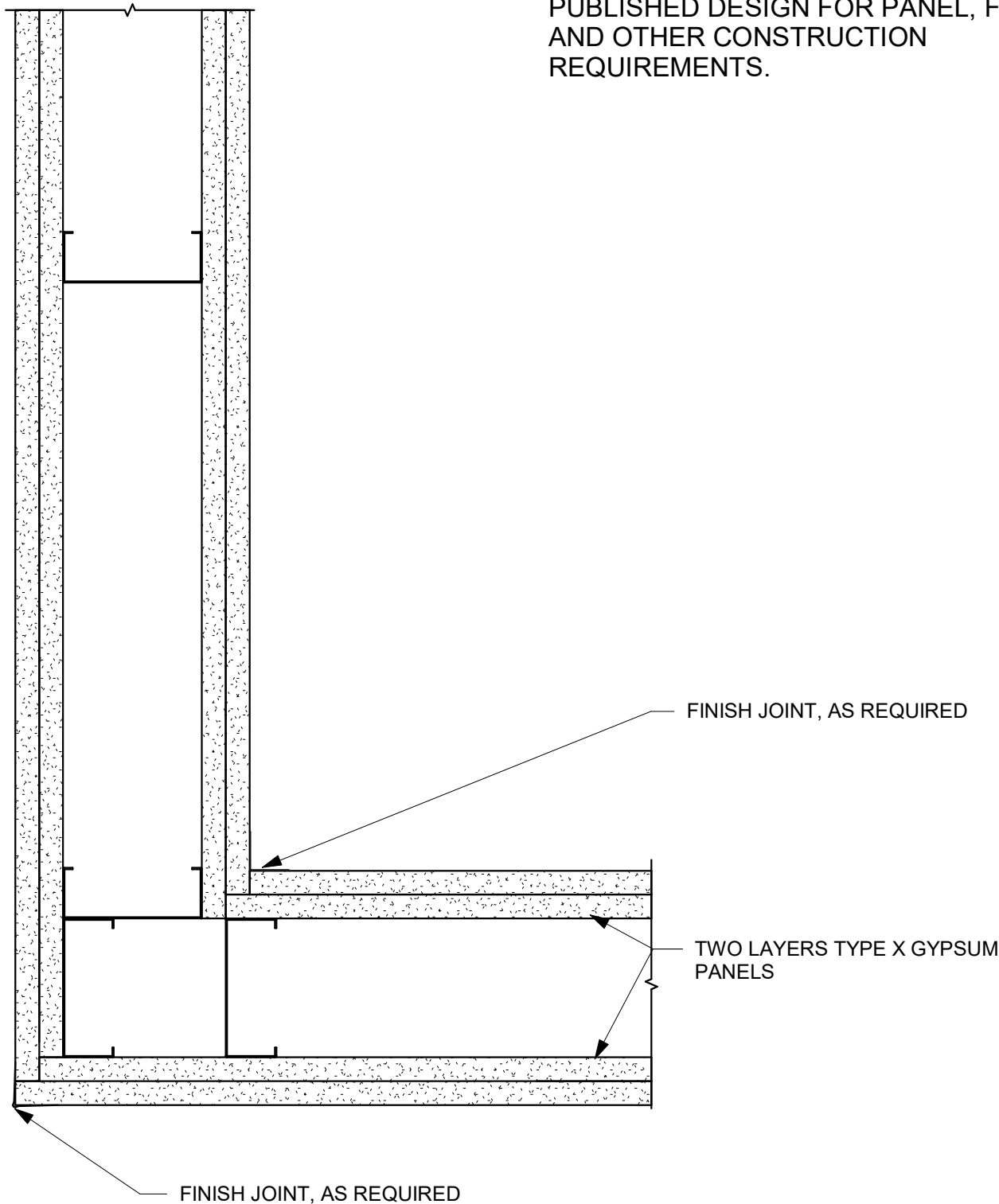

USG Corporation
550 West Adams Street
Chicago, IL 60661
T. 800-USG4YOU

CORNER DETAIL - STEEL STUD - 2HR

ISSUE RECORD:
06/12/20

SHEET INFORMATION:
WD-0001-D

DISCLAIMER: THE USG PRODUCT DETAILS CONTAINED HEREIN ARE INTENDED FOR USE AS PRODUCT REFERENCE MATERIAL BY ARCHITECTS, ENGINEERS, OTHER DESIGN PROFESSIONALS, CONTRACTORS, BUILDING CODE OFFICIALS, OR OTHER COMPETENT CONSTRUCTION INDUSTRY TRADE PROFESSIONALS HAVING AN INTEREST IN THE SELECTION, SPECIFICATION AND USE OF PRODUCTS MANUFACTURED BY THE SUBSIDIARIES OF USG CORPORATION. THE DRAWINGS ARE INTENDED SOLELY AS TECHNICAL SUPPORT INCIDENT TO THE SALE AND USE OF USG PRODUCTS AND NOT INTENDED TO BE A SUBSTITUTE FOR THE DESIGN REVIEW AND APPROVAL OF THE LICENSED DESIGN PROFESSIONALS FOR THE PROJECT. THESE MATERIALS MAY BE PRINTED AND/OR TRANSFERRED ELECTRONICALLY SOLELY AS NEEDED BY THE USER. BECAUSE CAD ELECTRONIC FILES AND BIM (BUILDING INFORMATION MODELING) FILES CAN BE MODIFIED BY OTHER PARTIES, WITHOUT NOTICE OR INDICATION OF SUCH MODIFICATIONS, MODIFICATION OF USG PRODUCT CAD DRAWINGS IS THE SOLE RESPONSIBILITY OF THE DESIGN PROFESSIONAL.

1 HOUR PARTITION

NOTE: THIS DETAIL DEPICTS A TYPICAL CORNER CONSTRUCTION. REFER TO THE PUBLISHED DESIGN FOR PANEL, FRAMING AND OTHER CONSTRUCTION REQUIREMENTS.

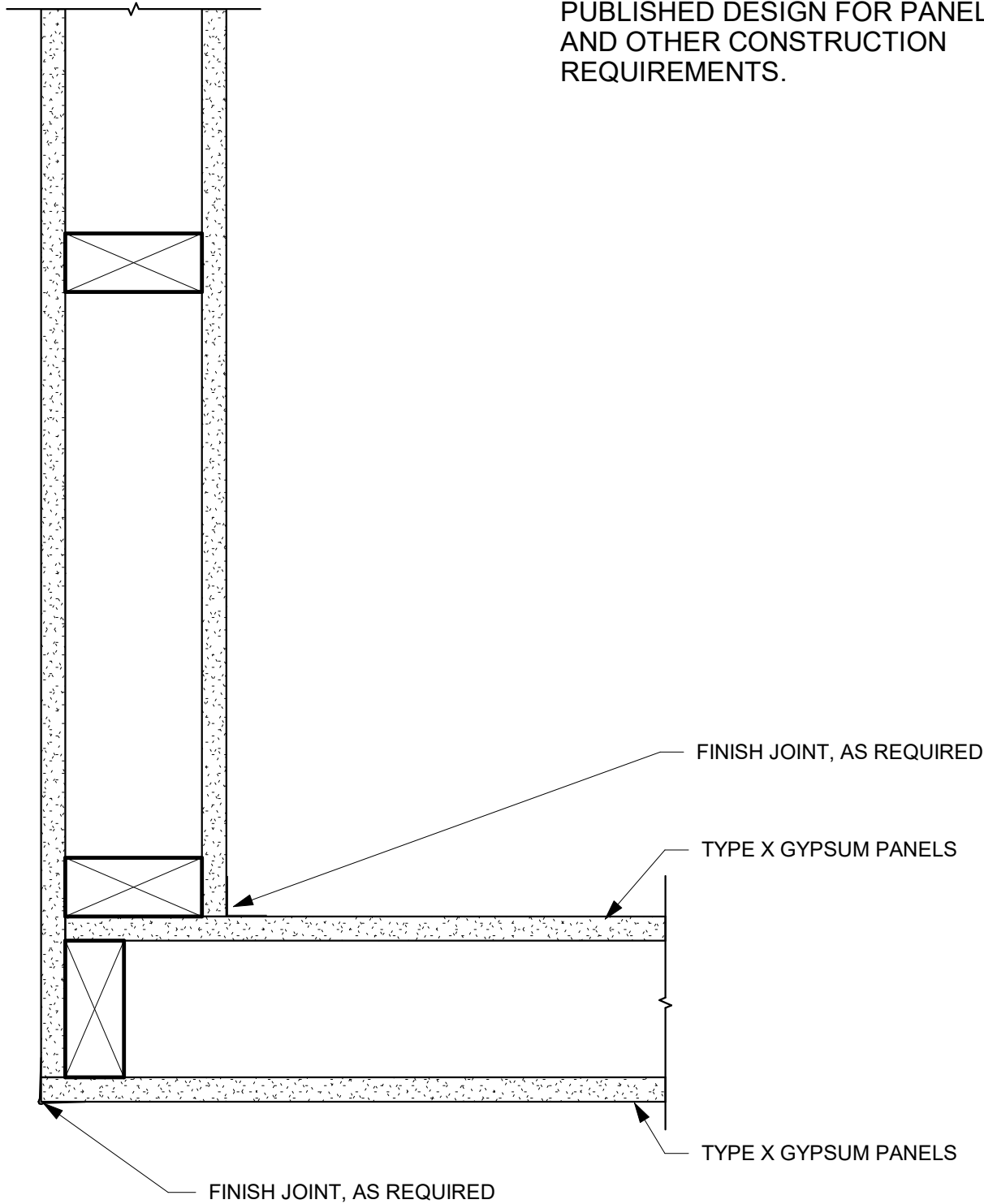

USG Corporation
550 West Adams Street
Chicago, IL 60661
T. 800-USG4YOU

CORNER DETAIL - WOOD STUD - 1HR

ISSUE RECORD:
06/12/20

SHEET INFORMATION:
WD-0001-E

1 HOUR PARTITION

NOTE: THIS DETAIL DEPICTS A TYPICAL CORNER CONSTRUCTION. REFER TO THE PUBLISHED DESIGN FOR PANEL, FRAMING AND OTHER CONSTRUCTION REQUIREMENTS.

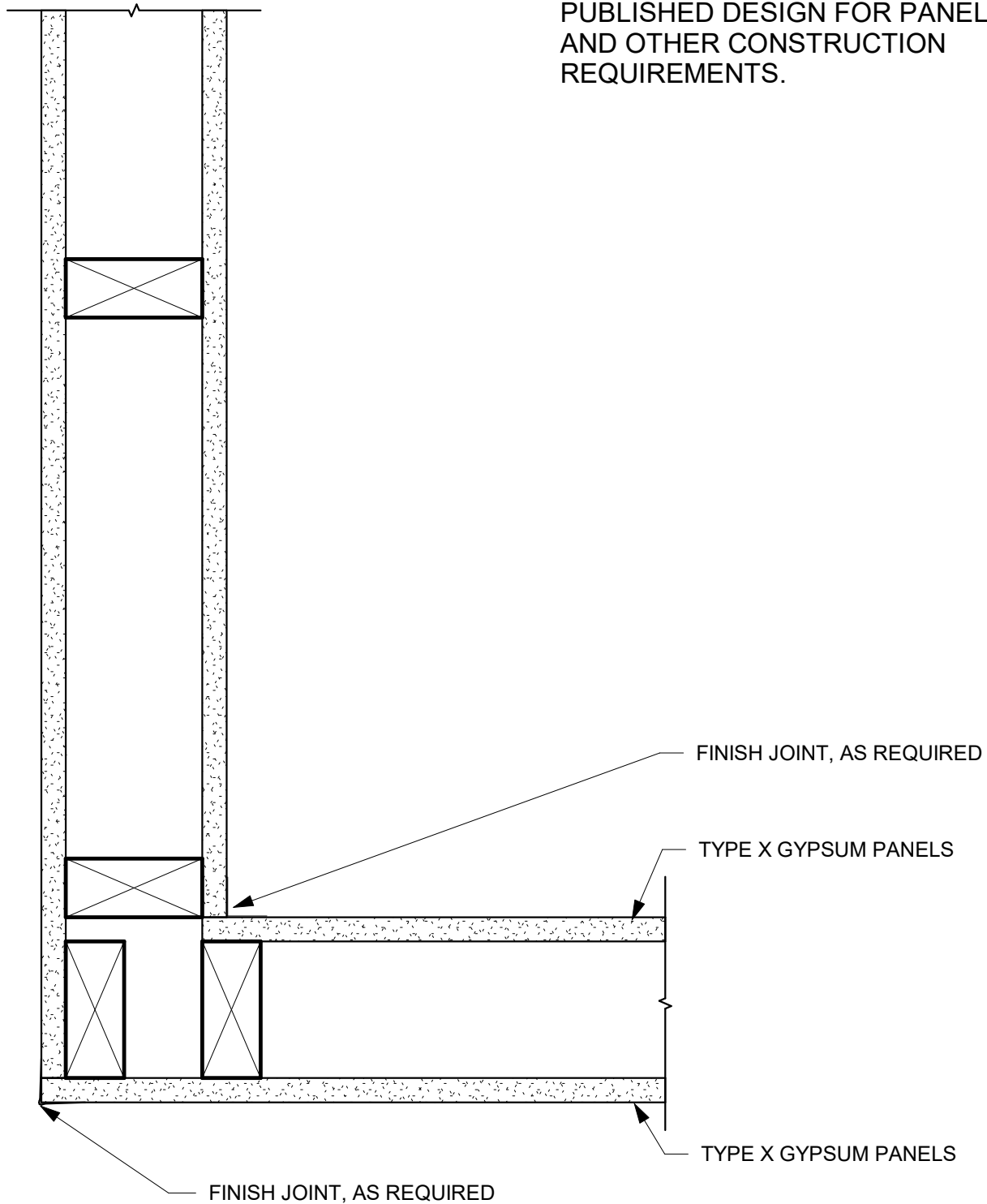

USG Corporation
550 West Adams Street
Chicago, IL 60661
T. 800-USG4YOU

CORNER DETAIL - WOOD STUD - 1HR

ISSUE RECORD:

06/12/20

SHEET INFORMATION:

WD-0001-F

DISCLAIMER: THE USG PRODUCT DETAILS CONTAINED HEREIN ARE INTENDED FOR USE AS PRODUCT REFERENCE MATERIAL BY ARCHITECTS, ENGINEERS, OTHER DESIGN PROFESSIONALS, CONTRACTORS, BUILDING CODE OFFICIALS, OR OTHER COMPETENT CONSTRUCTION INDUSTRY TRADE PROFESSIONALS HAVING AN INTEREST IN THE SELECTION, SPECIFICATION AND USE OF PRODUCTS MANUFACTURED BY THE SUBSIDIARIES OF USG CORPORATION. THE DRAWINGS ARE INTENDED SOLELY AS TECHNICAL SUPPORT INCIDENT TO THE SALE AND USE OF USG PRODUCTS AND NOT INTENDED TO BE A SUBSTITUTE FOR THE DESIGN REVIEW AND APPROVAL OF THE LICENSED DESIGN PROFESSIONALS FOR THE PROJECT. THESE MATERIALS MAY BE PRINTED AND/OR TRANSFERRED ELECTRONICALLY SOLELY AS NEEDED BY THE USER. BECAUSE CAD ELECTRONIC FILES AND BIM (BUILDING INFORMATION MODELING) FILES CAN BE MODIFIED BY OTHER PARTIES, WITHOUT NOTICE OR INDICATION OF SUCH MODIFICATIONS, MODIFICATION OF USG PRODUCT CAD DRAWINGS IS THE SOLE RESPONSIBILITY OF THE DESIGN PROFESSIONAL.

2 HOUR PARTITION

NOTE: THIS DETAIL DEPICTS A TYPICAL CORNER CONSTRUCTION. REFER TO THE PUBLISHED DESIGN FOR PANEL, FRAMING AND OTHER CONSTRUCTION REQUIREMENTS.

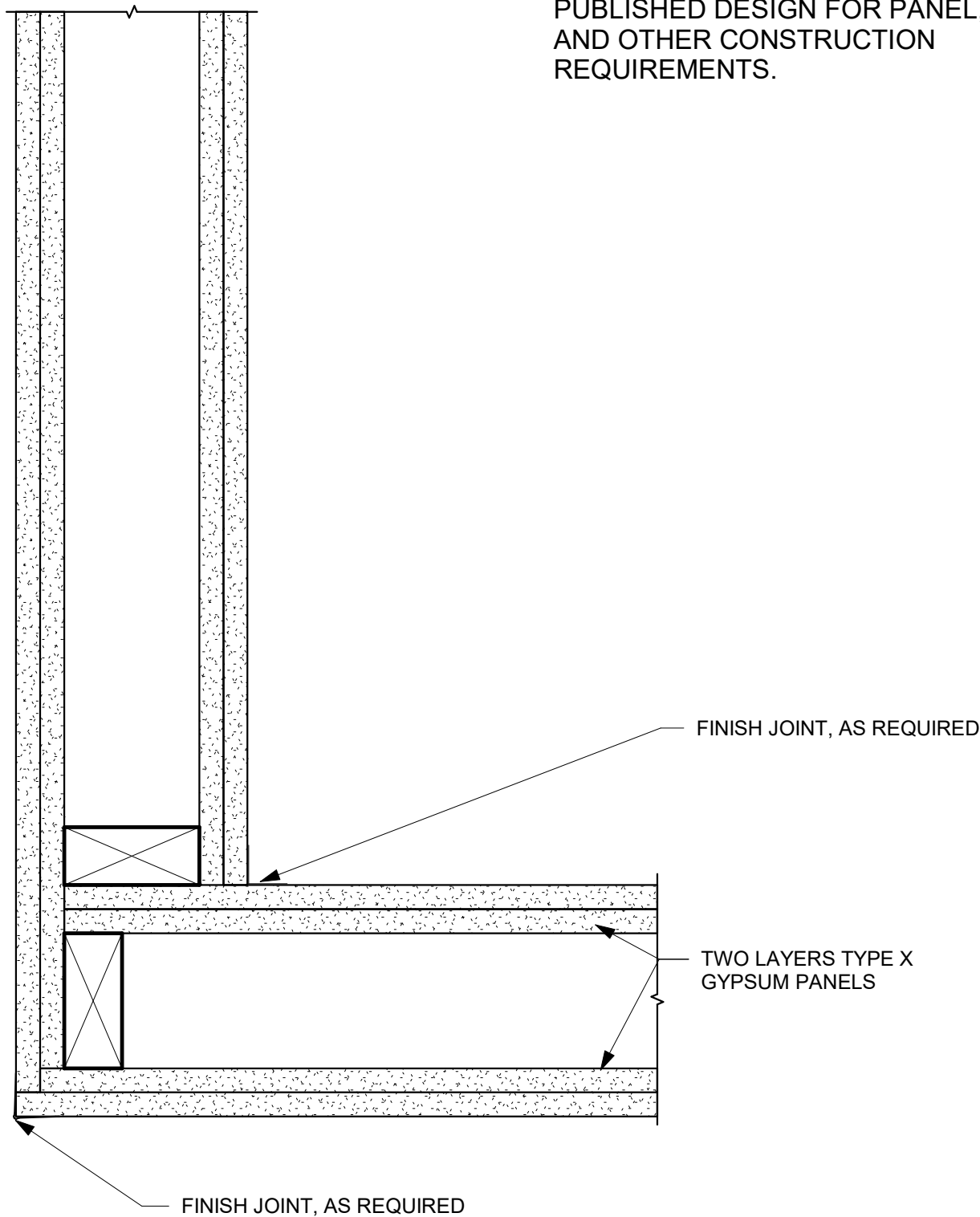

USG Corporation
550 West Adams Street
Chicago, IL 60661
T. 800-USG4YOU

CORNER DETAIL - WOOD STUD - 2HR

ISSUE RECORD:

06/12/20

SHEET INFORMATION:

WD-0001-G

DISCLAIMER: THE USG PRODUCT DETAILS CONTAINED HEREIN ARE INTENDED FOR USE AS PRODUCT REFERENCE MATERIAL BY ARCHITECTS, ENGINEERS, OTHER DESIGN PROFESSIONALS, CONTRACTORS, BUILDING CODE OFFICIALS, OR OTHER COMPETENT CONSTRUCTION INDUSTRY TRADE PROFESSIONALS HAVING AN INTEREST IN THE SELECTION, SPECIFICATION AND USE OF PRODUCTS MANUFACTURED BY THE SUBSIDIARIES OF USG CORPORATION. THE DRAWINGS ARE INTENDED SOLELY AS TECHNICAL SUPPORT INCIDENT TO THE SALE AND USE OF USG PRODUCTS AND NOT INTENDED TO BE A SUBSTITUTE FOR THE DESIGN REVIEW AND APPROVAL OF THE LICENSED DESIGN PROFESSIONALS FOR THE PROJECT. THESE MATERIALS MAY BE PRINTED AND/OR TRANSFERRED ELECTRONICALLY SOLELY AS NEEDED BY THE USER. BECAUSE CAD ELECTRONIC FILES AND BIM (BUILDING INFORMATION MODELING) FILES CAN BE MODIFIED BY OTHER PARTIES, WITHOUT NOTICE OR INDICATION OF SUCH MODIFICATIONS, MODIFICATION OF USG PRODUCT CAD DRAWINGS IS THE SOLE RESPONSIBILITY OF THE DESIGN PROFESSIONAL.

2 HOUR PARTITION

NOTE: THIS DETAIL DEPICTS A TYPICAL CORNER CONSTRUCTION. REFER TO THE PUBLISHED DESIGN FOR PANEL, FRAMING AND OTHER CONSTRUCTION REQUIREMENTS.

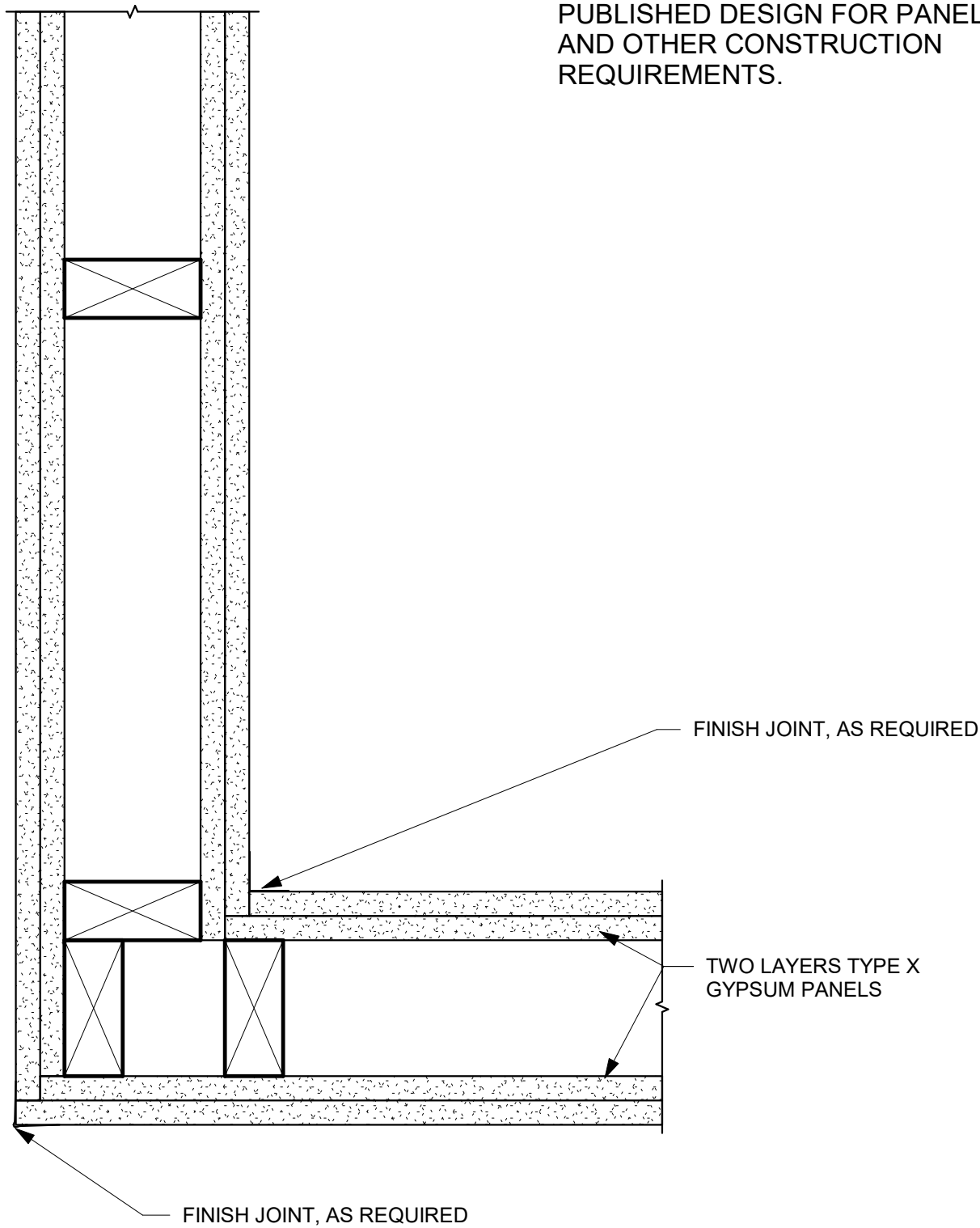

USG Corporation
550 West Adams Street
Chicago, IL 60661
T. 800-USG4YOU

CORNER DETAIL - WOOD STUD - 2HR

ISSUE RECORD:
06/12/20

SHEET INFORMATION:

WD-0001-H