

DESIGN NO. P230

FIRE-RESISTANCE RATING: 1 HOUR

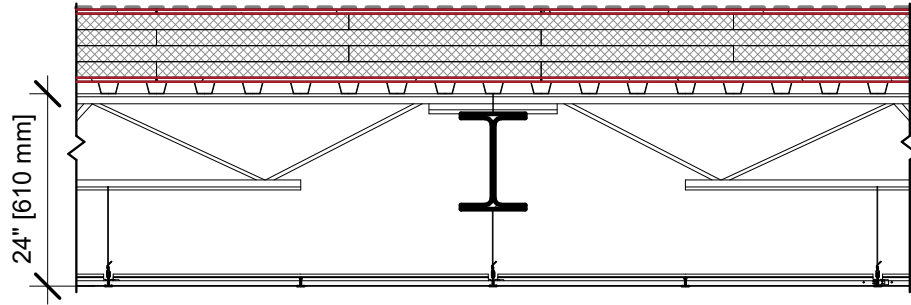

ASSEMBLY REQUIREMENTS:

ROOF COVERING	Single ply roofing membrane - per UL Design
COVERBOARD (OPTIONAL)	1/2" [12.7 mm] Securock Cement Board (UL Type DCB)
ROOF INSULATION	Formed Plastic - Total Thickness per UL Design
SHEATHING MATERIAL	Self adhered rubberized asphalt roofing underlayment
GYPSUM BOARD	1/2" [12.7 mm] Securock Cement Board (UL Type DCB)
ADHESIVE	Applied to crests of steel deck per UL Design
STEEL ROOF DECK	1 1/2" [38 mm] Min. Corrugated Steel Roof Deck
STEEL JOISTS	Steel Joists - 12k3 min. size, spaced at 4'-0" [1219 mm] O.C.
STEEL BEAM	Steel W-section Beam - Min W6x12
AIR SPACE	Air Space - dimension as noted
STEEL FRAMING MEMBERS	USG Drywall Suspension System (UL type DGL)
ACOUSTICAL CEILING PANELS	5/8" [15.8 mm] Acoustical Ceiling Panel (UL Type FR-83)

GENERAL ROOF-CEILING NOTES:

- FOR THE MOST UP-TO-DATE DETAILS, INCLUDING CONSTRUCTION VARIATIONS, REFER TO THE PUBLISHED ASSEMBLY IN THE UL PRODUCT IQ™ DATABASE OR GA DESIGN MANUAL.
- THIS ASSEMBLY IS FURNISHED AS IS, THE LICENSED PROFESSIONAL OF RECORD IS SOLELY RESPONSIBLE FOR THIS CONTENT.
- FRAMING SIZES AND INSULATION THICKNESS ARE MINIMUM UNLESS OTHERWISE STATED IN THE PUBLISHED ASSEMBLY.
- FRAMING AND FASTENER SPACINGS ARE MAXIMUM UNLESS OTHERWISE STATED IN THE PUBLISHED ASSEMBLY.
- PANEL ORIENTATION SHALL BE AS SPECIFIED IN THE PUBLISHED ASSEMBLY.
- REFER TO APPLICABLE CODES REQUIREMENTS TO ENSURE COMPLIANCE PRIOR TO CONSTRUCTION.

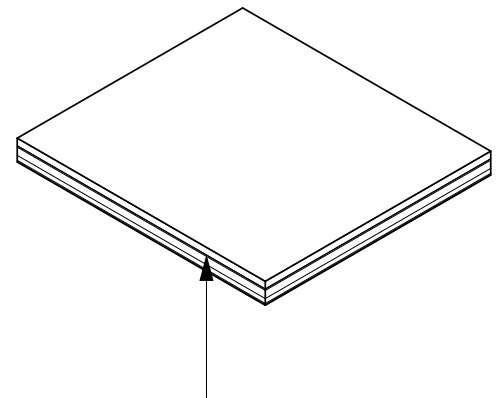

Revit System Family
(Copy & Paste into your Revit project)



United States Gypsum Company
550 West Adams Street
Chicago, IL 60661 USA

USG ROOFING ASSEMBLIES

DISCLAIMER: THE USG PRODUCT DETAILS CONTAINED HEREIN ARE INTENDED FOR USE AS PRODUCT REFERENCE MATERIAL BY ARCHITECTS, ENGINEERS, OTHER DESIGN PROFESSIONALS, CONTRACTORS, BUILDING CODE OFFICIALS, OR OTHER COMPETENT CONSTRUCTION INDUSTRY TRADE PROFESSIONALS HAVING AN INTEREST IN THE SELECTION, SPECIFICATION AND USE OF PRODUCTS MANUFACTURED BY THE SUBSIDIARIES OF USG CORPORATION. THE DRAWINGS ARE INTENDED SOLELY AS TECHNICAL SUPPORT INCIDENT TO THE SALE AND USE OF USG PRODUCTS AND NOT INTENDED TO BE A SUBSTITUTE FOR THE DESIGN REVIEW AND APPROVAL OF THE LICENSED DESIGN PROFESSIONALS FOR THE PROJECT. THESE MATERIALS MAY BE PRINTED AND/OR TRANSFERRED ELECTRONICALLY SOLELY AS NEEDED BY THE USER, BECAUSE CAD ELECTRONIC FILES AND BIM (BUILDING INFORMATION MODELING) FILES CAN BE MODIFIED BY OTHER PARTIES, WITHOUT NOTICE OR INDICATION OF SUCH MODIFICATIONS, MODIFICATION OF USG PRODUCT CAD AND BIM DRAWINGS IS THE SOLE RESPONSIBILITY OF THE DESIGN PROFESSIONAL. ©2023 USG CORPORATION.

ISSUE RECORD:

05/26/20

REV: DATE:

SCALE: 1/2" = 1'-0"

SHEET INFORMATION:

UL P230 - 1HR (UL type DCB)

P230 DCB