

# CLT with 2 mm LVT Double Levelrock 2500 pour to embed electrical conduit

STC = 57 IIC = 52  
HIIC = 55  
TEST # R0061.08-113-11-R0

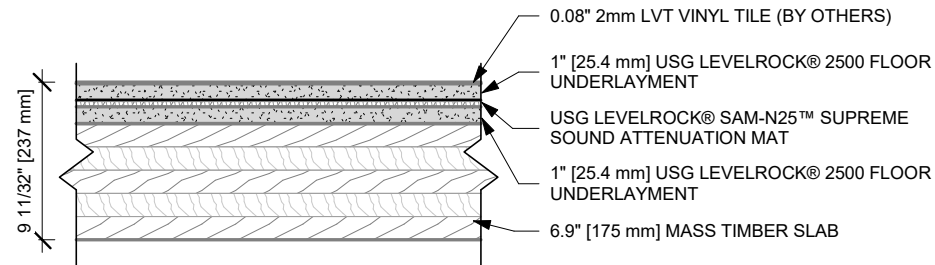

## GENERAL FLOOR CEILING NOTES:

- FOR THE MOST UP-TO-DATE DETAILS, INCLUDING CONSTRUCTION VARIATIONS, REFER TO THE PUBLISHED ASSEMBLY IN THE UL PRODUCT IQ™ DATABASE OR GA DESIGN MANUAL.
- THIS ASSEMBLY IS FURNISHED AS IS, THE LICENSED PROFESSIONAL OF RECORD IS SOLELY RESPONSIBLE FOR THIS CONTENT.
- FRAMING SIZES AND INSULATION THICKNESS ARE MINIMUM UNLESS OTHERWISE STATED IN THE PUBLISHED ASSEMBLY.
- FRAMING AND FASTENER SPACINGS ARE MAXIMUM UNLESS OTHERWISE STATED IN THE PUBLISHED ASSEMBLY.
- PANEL ORIENTATION SHALL BE AS SPECIFIED IN THE PUBLISHED ASSEMBLY.
- REFER TO APPLICABLE CODES REQUIREMENTS TO ENSURE COMPLIANCE PRIOR TO CONSTRUCTION.

Revit System Family  
(Copy & Paste into your Revit project)

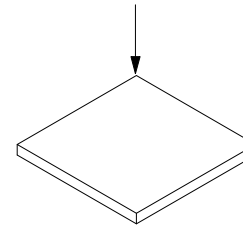

United States Gypsum Company  
550 West Adams Street  
Chicago, IL 60661 USA

Project Name

DISCLAIMER: THE USG PRODUCT DETAILS CONTAINED HEREIN ARE INTENDED FOR USE AS PRODUCT REFERENCE MATERIAL BY ARCHITECTS, ENGINEERS, OTHER DESIGN PROFESSIONALS, CONTRACTORS, BUILDING CODE OFFICIALS, OR OTHER COMPETENT CONSTRUCTION INDUSTRY PROFESSIONALS MAKING AN INVESTMENT IN THE SELECTION, SPECIFICATION AND USE OF PRODUCTS MANUFACTURED BY THE SUBSIDIARIES OF USG CORPORATION. THE DRAWINGS ARE INTENDED SOLELY AS TECHNICAL SUPPORT INCIDENT TO THE SALE AND USE OF USG PRODUCTS AND NOT INTENDED TO BE A SUBSTITUTE FOR THE DESIGN REVIEW AND APPROVAL OF THE LICENSED DESIGN PROFESSIONAL FOR THE PROJECT. THESE MATERIALS MAY BE PERIODICALLY REVISITED AND ELECTRONICALLY REVISITED BY THE USG CORPORATION AND ELECTRONIC FILES ARE BEING MAINTAINED BY USG CORPORATION. FILES CAN BE MODIFIED BY OTHER PARTIES. WITHOUT NOTICE OR INDICATION OF SUCH MODIFICATIONS, REVISIONS OF USG PRODUCT DATA DRAWINGS IS THE SOLE RESPONSIBILITY OF THE DESIGN PROFESSIONAL. USG/USG CORPORATION.

### ISSUE RECORD:

04/11/24

REV: DATE:

SCALE: 1 1/2" = 1'-0"

### SHEET INFORMATION:

5 ply CLT with double  
pour of Levelrock 2500

MT-DT-10-10753